



Venetian Blinds Product Brochure

www.shadow-system.pl

living with style





Horizontal blinds Also known as Venetian blinds, are one of the most popular products used for window decoration and shading. Their structure enables both pulling up and down of the blind, as well as setting horizontal slats at any angle. Together with the option of selecting the slat width, horizontal blinds ensure the widest adjustment of light penetration in the room among all available types of blinds and roller blinds. The possibility of using various materials such as aluminium, natural wood or bamboo as well as decorative accessories allows to give a completely different character- from modern to classical and stylish. A wide range of colours of aluminium and wooden slats enables matching and emphasizing a window cover in any room.

The full range of blinds in the Shadow-System offer include:

- **25 mm wooden blind:** a system matching visually every room regardless of its finishing style; you can choose your colour out of 39 options. A 25 mm wooden blind is available in three of the most popular versions of operation.
- **50 mm wooden blind:** window blinds ideal for elegant and modern interiors. There is a wide selection of 104 slat colours, allowing the possibility to select individual textiles and operating elements that enables to match blinds to every room.
- **50 mm Retro blind:** a blind which deserves special attention due to its exceptional decorative effect. A characteristic feature of Retro blinds is the use of wooden head rails with the blind operating mechanism attached. It is possible to use both a wooden and an aluminium slat.
- **25/16 mm aluminium blind:** the most popular aluminium blind with a slat width of 25 mm, and available in more than 120 colours, along with various options of coating. The 16 mm slat is the most slender and delicate type of aluminium blinds, and is available in 10 popular colours.
- **50 mm aluminium blind:** available in more than 30 colours, this is an ideal solution for medium-sized and large glazing. 50 mm aluminium blinds have a decorative function in making your space look modern.
- **Additional technical information** - the heights of packages, the quantities and the location of cords and ladders, as well as the colours of operating tassels.
- Solutions and detailed information on **Electric motors and controls SOMFY®**, **COULLISSE** and **BREL** are also available.

Details
on pages
11 - 14

Details
on pages
15 - 20

Details
on pages
21 - 23

Details
on pages
24 - 30

Details
on pages
31 - 36

Details
on pages
37 - 43

Details
on pages
44 - 53



SHADOW-SYSTEM is a Polish company from the Tri-city area with over 20-year experience in production of exclusive window products. Our main goal is to find and offer our customer an optimal solution for the window decoration so that our premium blinds, produced with greatest care, bring full satisfaction from the every-day use. Our mission is to create the market of cover products, combining the highest quality, functionality and aesthetics.



Electric motors: Technological developments have provided many solutions in our everyday life which improve the functionality of household appliances, while at the same time contributing to our home comforts. Our horizontal blinds can be equipped with electrical elements which can be controlled by phone or tablet from anywhere in the world.

The extensive range of products available for having a remote-controlled system of blinds always allows the possibility of finding optimal solutions. Thanks to modern management systems, it is possible to control your blinds in several rooms by means of a multi-functional remote control panel or an application on your phone. The control units of a smart home enable the user to programme appropriate operating modes for particular times of the day and days of the week, so that blinds can be pulled up or down automatically depending on the expectations of household members.



A single-channel remote control panel with the VARIATION function for controlling the turning of slats, which controls one blind or a group of blinds in one room by means of a radio signal.



16-channel remote control panel controls a maximum of 16 blinds, or group of blinds, in several rooms. There is an LCD remote control panel.



TaHoma Switch control centre in smart home Enables the control of multiple home devices via internet.



A 15-channel wall switch, supplied with a battery, has a clear display with an extremely intuitive operation.



A 15-channel remote control including a "TILT" function, which makes it possible to tilt the slats. The set includes a magnetic wall holder.



More technical information on electric motors on pages 44- 53.



Employees. We believe that people create the company's value and determine its success. Highly qualified and experienced employees are a guarantee of highest quality of the products we produce. The core of our staff consists of experienced employees, attached to the company from almost the very beginning of its existence, who with their knowledge and experience support the new ones who have just started their adventure with our company. All our customers can count on comprehensive and professional support from our employees in order to obtain the product which is best tailored for their needs and expectations.



FINISHING STANDARDS HORIZONTAL BLINDS

The wide range of Shadow-System horizontal blinds includes wooden blinds with the option of 25 mm and 50 mm slats, and aluminium blinds available in 16 mm, 25 mm and 50 mm. The production technology and design for any given group of products requires the use of various finishing standards. The most important finishing and installation elements of our products are presented below.

STANDARD OPERATION:

25 mm BLINDS

Cord-wand operation. These are 25 mm blinds, wooden and aluminium, which are operated with a cord and a wand. A polyester cord with a thickness of 1.4 mm and reinforced resistance to wearing is used for pulling up the blind slats. A wand made of transparent plastic is used for turning aluminium blinds, and a wooden wand for wooden blinds.



When placing an order, choose the side (left or right) on which the blind operating mechanism – cord and wand – will be located. It is possible to place a cord and a wand on opposite sides of the blind. If the blind width does not exceed 32 cm, the wand for turning the slats is always placed on the opposite side of the cord used for pulling up the blinds. Typically, blind operating mechanisms (cord and wand) have a length that is 65% of the total blind height; it can be customized to different lengths, but the maximum wand length is 1.5 metres for wooden blinds and 3 metres for aluminium blinds.



50 MM BLINDS:

Cord-cord operaton. The 50mm blinds, both wooden and aluminium, are operated with operating cords. Cords with a thickness of 1.7 mm and 2.8 mm, used for pulling up and turning slats, are made of polyester with reinforced resistance to wearing.

When placing your order, choose the side (right or left) on which the operating cords of the blind will be placed. It is possible to place a cord on the opposite sides of the blind for pulling up and slat turning. If the blind width does not exceed 53 cm, then the cords for turning the slats are always placed on the opposite side of the cord used for pulling up the blinds. Typically, operating cords have a length that is 65% of the total blind height – it can be customized to different lengths.

OPTIONAL OPERATION:

WOODEN BLINDS 25 mm and ALUMINIUM BLINDS 25 / 16 mm



BLIND 25 mm - **MONO CHAIN**
endless chain



BLIND 25 mm - **MONOMAGIC**
cord integrated with the wand
(aluminium blinds 25 / 16 mm only)



BLIND 25 mm - **MOTOR**

WOODEN and ALUMINIUM BLINDS 50 mm



BLIND 50 mm - **MONO CHAIN**
endless chain



BLIND 50 mm - **MONO CORD**



BLIND 50 mm - **WITH MOTOR**



BLIND 50 mm - **CRANK**

RETRO BLINDS 50 mm

RETRO blind has two available operating versions – cord-cord and cord-wand. The cord-cord mechanism is available in four colours – white, black, silver and 'old brass'. The cord-wand mechanism is available only in the 'old brass' colour. As far as the RETRO blinds are concerned, it is possible to use both a wooden and an aluminium slat with a width of 50 mm.



When placing an order, choose a side on which the blind operating mechanism (cord-cord or cord-wand) will be located. If the blind width does not exceed 53 cm, then the cord/wand for turning the slats are always placed on the opposite side of the cord used for pulling up the blinds. Typically, blind operating mechanisms (cord and wand) have a length that is 65% of the total blind height – it can be customized to different lengths but the maximum wand length is 1.2 metres for Retro blinds.

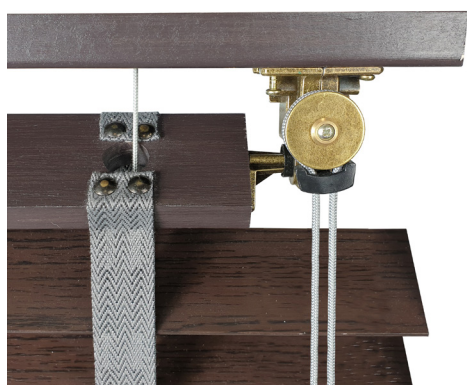

CORD-CORD OPERATION
(rotating the slats with a cord)



CORD-WAND OPERATION
(rotating the slats with a wand)

BLIND'S CONSTRUCTION ELEMENTS

ALUMINIUM BLINDS

Steel head and bottom rails – in colours as close as possible to the colour of the aluminium slat – are used for the production of aluminium blinds (16, 25 and 50 mm) in the standard version. Both the head rail and bottom rails are ended with composite side end cap for 25/16 mm blinds made of polycarbonate, transparent or anthracite, and for 50 mm blinds made of PVC in the colour of the rail.

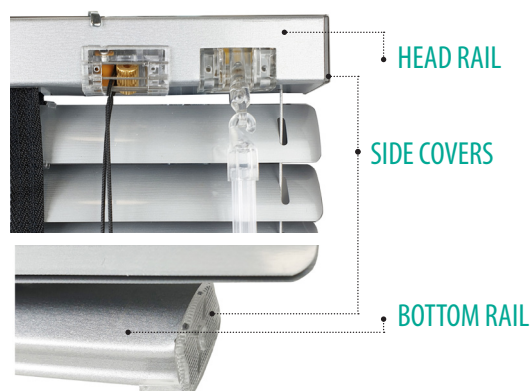

ALUMINIUM BLIND
16 / 25 MM

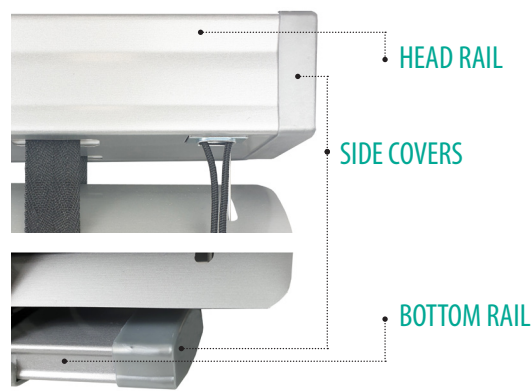

ALUMINIUM BLIND
50 MM

WOODEN BLINDS

As far as wooden blinds (25 and 50mm) are concerned, the head rail is made of steel in colours as close as possible to the wooden slat colour, whereas the bottom rail is wooden and so its colour is consistent with the slat colour. In the standard version, the head rail is covered with a front wooden cover in the slat colour. Optionally, the head rail cover can be made with additional sides at its ends.



WOODEN BLIND
25 MM



WOODEN BLIND
50 MM

Retro BLINDS

With RETRO blinds, the upper, middle and bottom rails are made of wood -all these elements are selected in accordance with the colour of the slats.



RETRO WOODEN
BLIND 50 mm

MECHANISM COVERS:

16 and 25 mm aluminium blinds may optionally (without any extra charge) be equipped with polycarbonate covers for the mechanisms. The covers are available in two colours – transparent and anthracite.

BLIND WITH NO COVERS



TRANSPARENT COVERS



ANTHRACITE COVERS



TASSELS FOR AN OPERATING CORD:

Aluminium blinds as the basic version are equipped with cord tassels made of transparent polycarbonate. At an extra cost, it is possible to use wooden or metal tassels.

Wooden blinds are equipped with cord tassels made of wood – standard tassels are a “sleeve”, although the “barrel” option is available free of charge. At an extra cost, it is possible to use metal tassels which are also available in two sizes.



STANDARD CORD TASSEL
TRANSPARENT
ALUMINIUM BLINDS



STANDARD CORD TASSEL
„WOODEN SLEEVE”
WOODEN BLINDS



OPTIONAL CORD TASSEL
„BARREL”
(NO EXTRA CHARGE)



OPTIONAL CORD TASSEL
„METAL SLEEVE”
(WITH EXTRA CHARGE)



All the tassels versions are available in two sizes: small, which is dedicated to 25 mm blinds, and large, dedicated to 50 mm blinds.

LADDERCORDS AND LADDERTAPES:

All the basic version horizontal blinds are equipped with laddercord. The colour of the laddercord is matched with the slat as close a colour as possible. For an extra charge, it is possible to use a laddertape with a width of 12 mm for a 25 mm blind (wooden bambus slats only), and 25 and 38 mm for a 50 mm blind.

LADDERCORD



LADDERTAPE
12 mm



LADDERTAPE
25 mm



LADDERTAPE
38 mm



For RETRO blinds, a 25 mm laddertape is used as standard, and the option of a laddertape with a width of 38 mm is available free of charge.

MOUNTING:

ALUMINIUM and WOODEN BLINDS 16 / 25 mm

The installation of 16 and 25 mm horizontal blinds is carried out with the use of two twist type holders (zinc plated steel). There is the choice of universal, which enables installation on the wall and on the ceiling, and also ceiling, which is installed only on the ceiling. Optionally, a non-invasive block holder (at an extra charge) is also available, dedicated to installation on the window frame, and a clamp made of transparent polycarbonate.

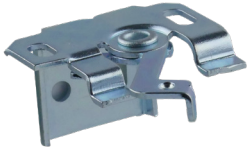

UNIVERSAL TWIST
HOLDER
MOUNTING: WALL / CEILING
(STANDARD)



CEILING TWIST
HOLDER
MOUNTING: CEILING
(NO EXTRA CHARGE)



PLASTIC
CLAMP
MOUNTING: WALL / CEILING
(WITH EXTRA CHARGE)



NON-INVASIVE
BLOCK HOLDER
ZACISKANY NA SKRZYDLE OKNA
(WITH EXTRA CHARGE)

ALUMINIUM and WOODEN BLINDS 50 mm

The installation of 50 mm blinds is carried out with the use of the standard twist type holders (zinc plated steel), enabling installation on the wall and on the ceiling. At an extra charge, a clamp made of zinc plated steel is also available.



UNIVERSAL TWIST HOLDER
MOUNTING: WALL / CEILING
(STANDARD)

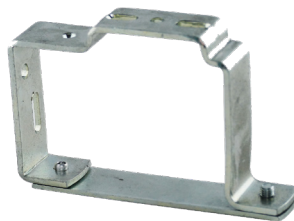

CLAMP
MOUNTING: WALL / CEILING
(WITH EXTRA CHARGE)



SIDE MOUNTING HOLDER
MOUNTING: WINDOW SASH
(WITH EXTRA CHARGE)

RETRO BLINDS 50 mm

The installation of RETRO blinds is carried out with the use of the standard universal C type holder (painted steel), enabling installation on the wall and on the ceiling. Optionally, an F type angular holder (anodized aluminium) is also available.

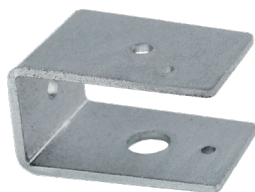

„C”TYPE UNIVERSAL
HOLDER
MOUNTING: WALL / CEILING
(STANDARD)

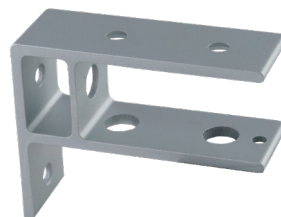

„F”TYPE ANGULAR
HOLDER
MOUNTING: WALL / CEILING
(WITH EXTRA CHARGE)



WOODEN BLINDS

Wooden blinds are the most exclusive form of sun shades installed in the interior. The natural beauty of wooden slats that form the blind give an elegant and timeless character to a room. They are perfect both for modern and classical interiors, functioning not only as protection against the sun, but also as a window decoration, affecting the appearance of the whole room significantly.

Slat widths available

25 mm

50 mm

WOODEN BLINDS COLLECTION BOOK

Our collection includes 100 colours of wooden blind slats with a width of 50 mm and nearly 40 colours of slats with a width of 25 mm. In order to simplify the use of patterns book, slats are combined in packages and arranged according to colours. Apart from slat packages, the collection catalogue includes a complete pattern book of textiles and tassels for operating cords. As a supplement to the slats collection, we have prepared a catalogue with technical components which will greatly facilitate the presentation of the horizontal blinds available.



WOODEN BLINDS - 25 mm

25 mm wooden blinds are subtle variation of horizontal wooden blinds, providing lots of arrangement possibilities, especially in small rooms and on small windows. The compact system sizes allow for a non-invasive blind installation in the window pane without any drilling in the window frame or glazing beads. 25 mm wooden blinds are offered in three operating versions - cord-wand, mono chain and motor. Our permanent collection includes 39 slats in various colours and 16 colours of the decorative laddertape with a width of 12 mm as additional option.



Technical data:

Width:*	min. 22 cm max. 270 cm max. 180 cm - Bamboo
Height:*	300 cm
Slat width:	25 - 27 mm
Slat thickness:	2 - 3 mm
Recommended max. surface:*	4,00 m ²
Colours:	according to the current pattern of wooden slats

* depending on the blind model and selected slat

Types of operation:

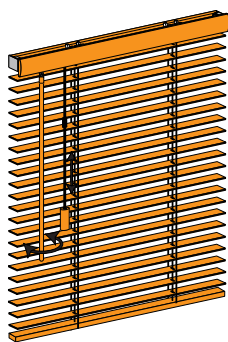

1. cord - wand

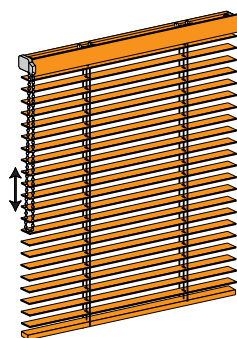

2. endless chain

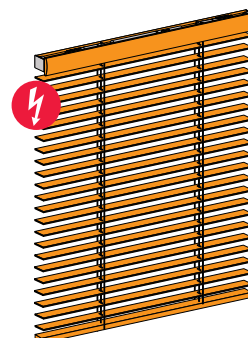

3. motor

Electric motors for wooden blinds 25 mm:

LW25 B83



somfy.

The motor with the nominal torque of 0.8 Nm. Installed centrally, with integrated brake and overload limiter. The motor design ensures a silent and reliable operation.

TILT&LIFT 25 RTS



somfy.

The motor suitable for 12 V voltage – battery power supply with an option of using a solar panel or by means of a plug-in AC power adapter. Controlled with an RTS radio signal.

More technical information on motors on pages 44 - 53

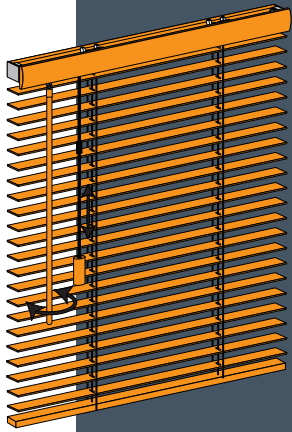

HJ 25-01
Standard blind
with a cord-wand operation

width: min. 0,30 m
max. 2,70 m
max. 1,80 m (Bamboo)

height: min. 0,30 m
max. 3,00 m

surface: max. recommended 4,00 m²

operation: lifting - cord
rotating - wand

wand length: max. 1,5 m

ADDITIONAL OPTIONS

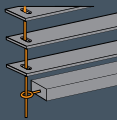

side guiding
page 14

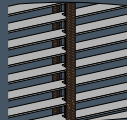

laddertape 12 mm
(only bambus wood)
page 14

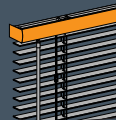

head rail cover
with sides
page 14



optional tassels for
operating cords
page 14

PROFILE

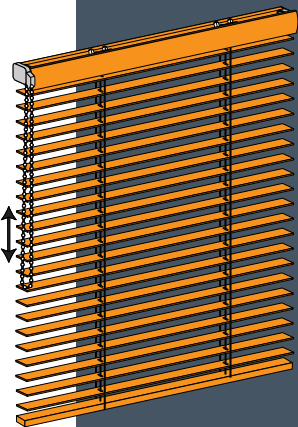
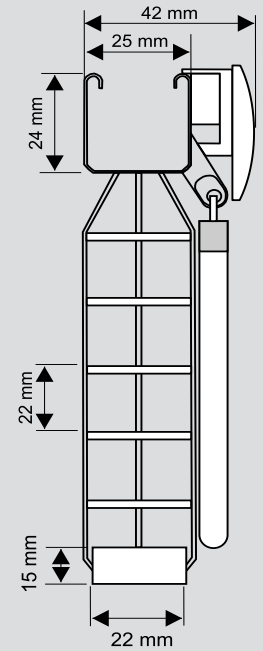

HJ 25-03
Mono chain blind
with an endless chain operation

width: min. 0,30 m
max. 2,70 m
max. 1,80 m (Bamboo)

height: min. 0,30 m
max. 3,00 m

surface: max. recommended 2,20 m²

operation: lifting - chain
rotating - chain

ADDITIONAL OPTIONS

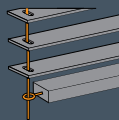

side guiding
page 14

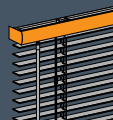

head rail cover
with sides
page 14

PROFILE

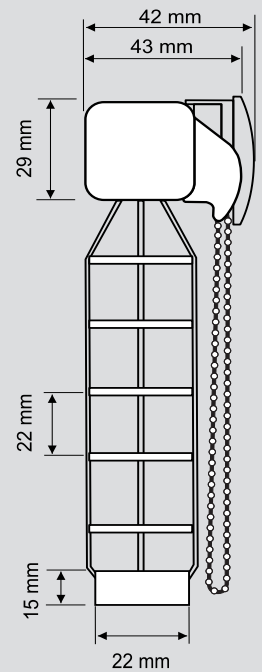

COLOURS OF MECHANISMS

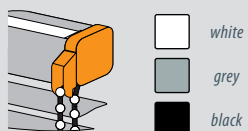

COLOURS OF CHAIN

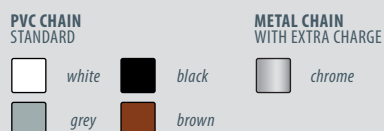

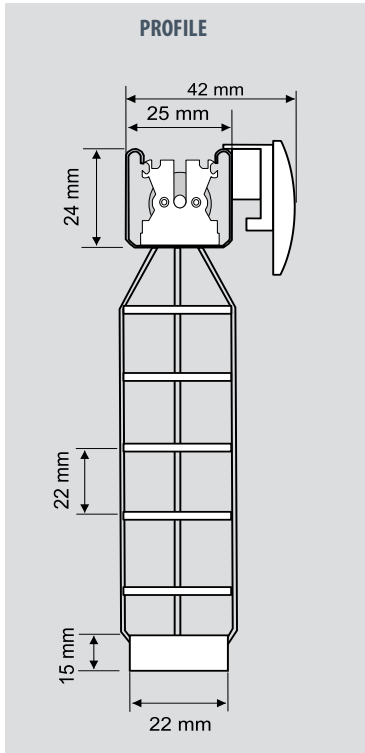

HJ 25-05
Motor operated blind

width: min. 0,60 m*
max. 2,70 m
max. 1,80 m (Bamboo)

height: min. 0,50 m
max. 3,00 m

surface: max. recommended 3,50 m²

operation: lifting - motor
rotating - motor

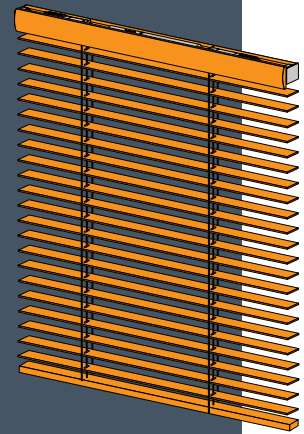

ADDITIONAL OPTIONS

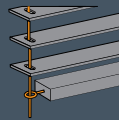

side guiding

page 14

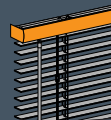

head rail cover
with sides

page 14

* depending on the model

TYPES OF MOUNTING

STANDARD MOUNTING

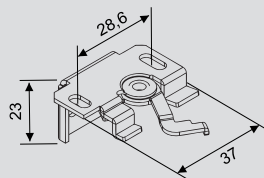

universal twist holder

OPTIONAL MOUNTING

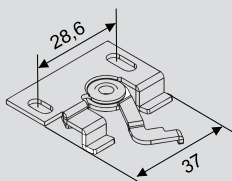

ceiling twist holder
(no extra charge)

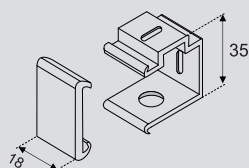

plastic clamp
(with extra charge)

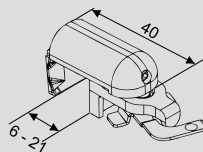

non-invasive block holder
(with extra charge)

MOUNTING THE BOTTOM RAIL

A bracket (zinc plated steel) for fixing the bottom rail to prevent the blind from moving when the window is tilted.

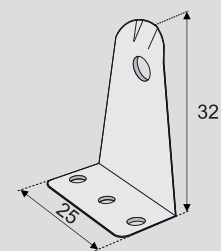

bottom rail bracket
(with extra charge)

NON-INVASIVE FIXING TO PVC WINDOWS

These are special holders that enable the installation of a blind on the window frame without necessity of drilling holes into its frame. A blind mounted this way may be quickly dismantled without leaving any mark.

Available colours

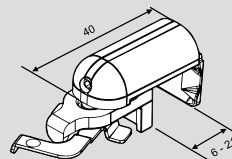

Clamp holder for non-invasive installation on the window frame.

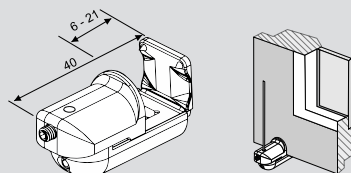

Clamp holder for non-invasive installation of the side guiding cord.



ADDITIONAL OPTIONS FOR WOODEN BLINDS 25 mm



LADDERTAPE 12 MM

Laddertape 12 mm - made of polyester and coloured with durable pigments, and subject to decatising in the production process, which guarantees low extensibility and high strength. Resistant to UV radiation, wearing and fading. A laddertape gives a better darkening effect by covering the holes in the slats through which a cord is placed for pulling up the blinds. A laddertape underlines the style of the blind perfectly.

The use of a 12 mm laddertape in a venetian blinds 25 mm limits the possibility of fully closing the shutter.

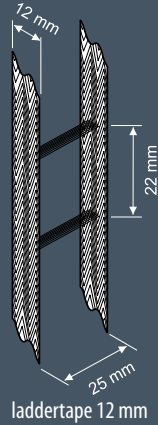

*only for bambus slats



HEAD RAIL COVER WITH SIDES

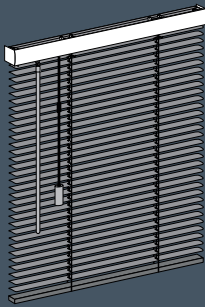

Head rail cover with sides - a standard head rail cover is additionally equipped with side endings mounted on side (R/L) or on both.



TASSELS FOR AN OPERATING CORD

Tassels for an operating cords - there is option to change standard operating tassel "sleeves" to either a "metal sleeve" at an extra charge, or a "wooden barrel" for free.

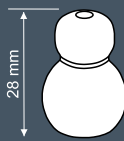

small „Barrel“

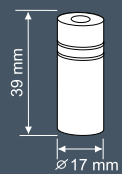

small „Wooden Sleeve“

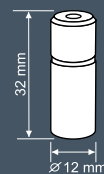

small „Metal Sleeve“

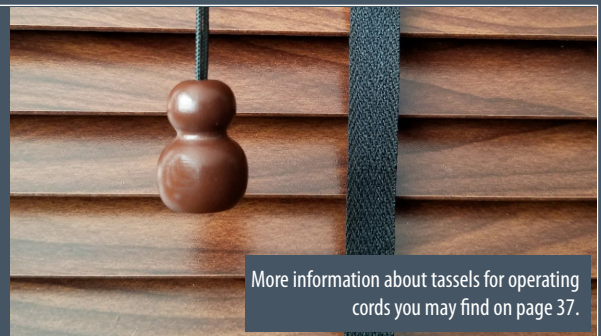

More information about tassels for operating cords you may find on page 37.



SIDE GUIDING

Side guiding - This ensures holding the blind in the plain of the window frame during opening or tilting. A steel line with a thickness of 1.2 mm in a perlon jacket fits through the holes on both ends of the slats. The lines are tightened with tensioning springs in the head blind rail, and the bottom mounting holders are selected depending on the needs and mounting possibilities.

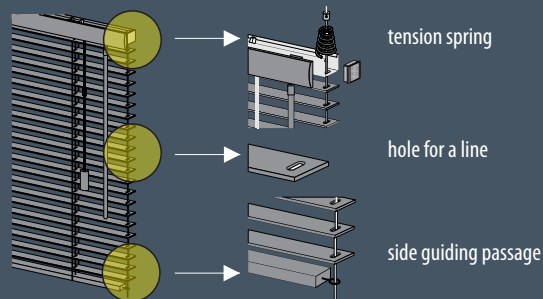

Mounting holders of side guiding



Holder, made of transparent polycarbonate, on the glazing bead mounting.

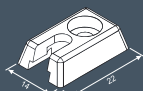

Angular holder, made of transparent polycarbonate, for mounting on the window frame.

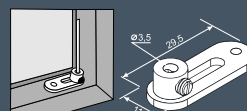
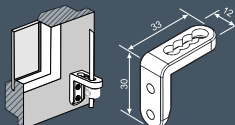

Holder, made of painted steel, for mounting on the glazing bead. Colours: white, grey, brown, black.

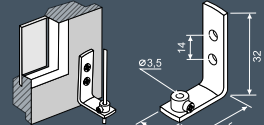

Angular holder, made of steel, for mounting on the window frame.

WOODEN BLINDS - 50 mm

Wooden blinds 50 mm are an elegant and functional solution for medium-sized and large glazings. These are available in 104 colours with the possibility of individual selections of textiles and operating elements. Being able to personalise these will allow matching the blind with every kind of style from the Scandinavian through, industrial to classical and more elegant. 50 mm wooden blinds are produced in a STANDARD version with a steel head rail and wooden head rail cover, and in the RETRO version with a wooden head and middle rail, and with an external decorative operating mechanism.



Technical data:

Maximum dimensions:*	width from 240 to 270 cm (depending on the selected slat) max. width 360 cm - S-5020, S-502, S-5029 height 400 cm max. 3 m - Abachi Collection
Slat width:	50 mm
Slat thickness:	2 - 3 mm
Recommended max. surface:*	8,00 m ²
Colour:	according to the current pattern of wooden slats

* depending on the blind model and selected slat

Types of operation:

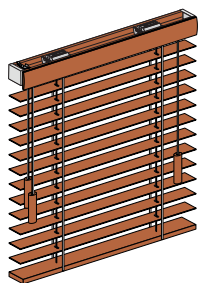

1. cord - cord

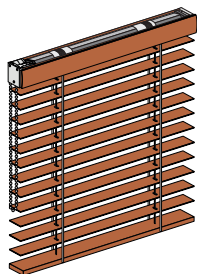

2. endless chain

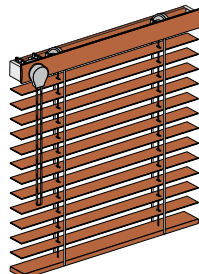

3. endless cord

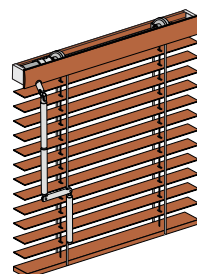

4. crank

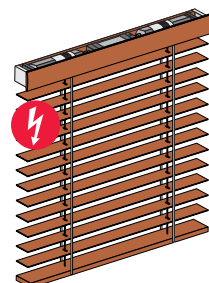

5. motor

Motors for wooden blinds 50 mm:

Sonessa 40 PA / RTS



Compact and silent motor supplied with 230 V. Operation below 45 dB. Nominal torque from 3 Nm to 9 Nm depending on the model selected. Controlled by means of a cable (PA), radio (RTS) or radio by means of io-homecontrol (io) technology.

BREL BLE 35



The motor is supplied with an integrated multiple charging battery, with a nominal torque of 10 Nm. Operated by means of a remote control device or wall switch.

J4 WT / RTS



The motor for heavy wooden blinds, ensuring the stable and uniform pulling-up of slats. J4 series engines are louder than Sonessa motors and are used only at the customer's request in exceptional installation conditions.

More technical information on motors on pages 44 - 53

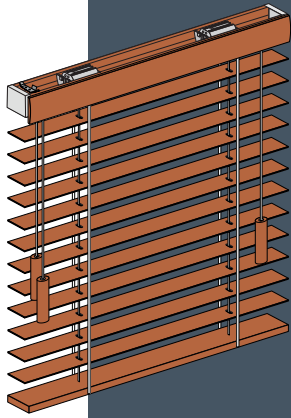

HJ 50-02
Standard blind

with a cord - cord operation

width: min. 0,35 m
max. 240 - 270 cm
(depending on the selected slat)
max. 3,60 m (slats: S-5020, S-5021 i S-5029)
max. 3 m - Abachi Collection

height: min. 0,40 m
max. 3,50 m

surface: max. recommended 6,00 m²/ 12 kg

operation: lifting - cord
rotating - cord

ADDITIONAL OPTIONS

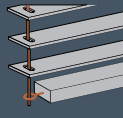

side guiding
page 19

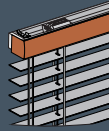

head rail cover
with sides
page 19

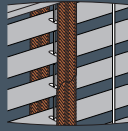

laddertape
25 / 38 mm
page 20

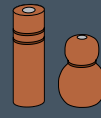

optional tassels for
operating cords
page 20

PROFILE

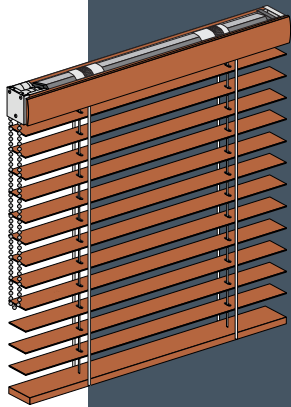
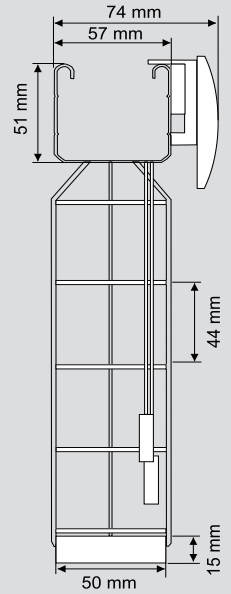

HJ 50-03
Mono chain blind

with an endless chain operation

width: min. 0,40 m
max. 240 - 270 cm
(depending on the selected slat)
max. 3,60 m (slats: S-5020, S-5021 i S-5029)
max. 3 m - Abachi Collection

height: min. 0,40 m
max. 3,50 m

surface: max. recommended 4,00 m² / 8 kg

operation: lifting - chain
rotating - chain

ADDITIONAL OPTIONS

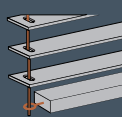

side guiding
page 19

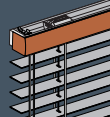

head rail cover
with sides
page 19

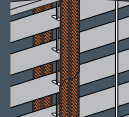

laddertape
25 / 38 mm
page 20

PROFILE

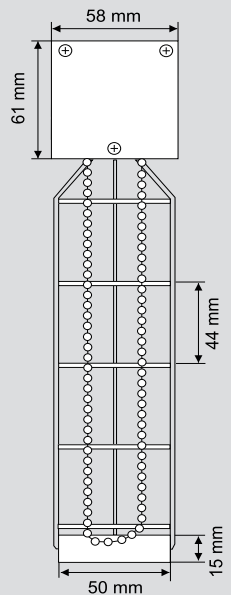

COLOURS OF CHAIN

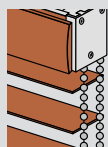

PVC CHAIN - STANDARD

white black
grey brown

METAL CHAIN - WITH EXTRA CHARGE

chrome

MECHANISM COVER COLOURS

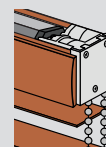

white sand off white
grey gold oak black

PROFILE

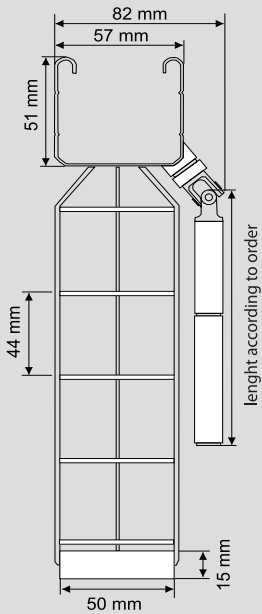

HJ 50-04
Crank operated blind

- width: min. 0,40 m
max. 240 - 270 cm
(depending on the selected slat)
max. 3,60 m (slats: S-5020, S-5021 i S-5029)
max. 3 m - Abachi Collection
- height: min. 0,40 m
max. 3,50 m
- surface: max. recommended 7,00 m²
- operation: lifting - crank
rotating - crank
- crank length: max. 4,00 m

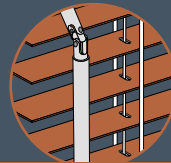

Fixed crank

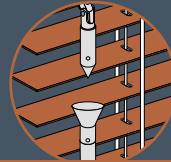

Detachable crank

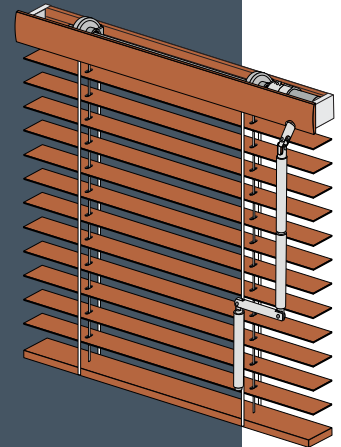

ADDITIONAL OPTIONS

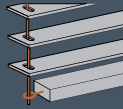

side guiding
page 19

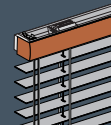

head rail cover
with sides
page 19

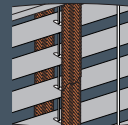

laddertape
38 mm
page 20

PROFILE

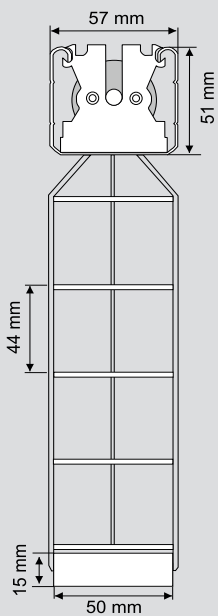

HJ 50-05
Motor operated blind

- width: min. 0,65 m
max. 240 - 270 cm
(depending on the selected slat)
max. 3,60 m (slats: S-5020, S-5021 i S-5029)
max. 3 m - Abachi Collection
- height: min. 0,50 m
max. 4,00 m
- surface: max. recommended 8,00 m²
- operation: lifting - motor
rotating - motor

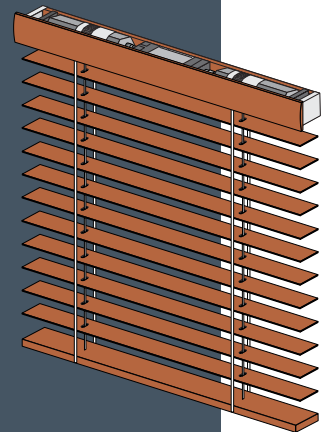

ADDITIONAL OPTIONS

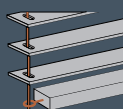

side guiding
page 19

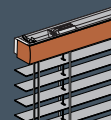

head rail cover
with sides
page 19

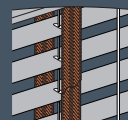

laddertape
25 / 38 mm
page 20



**TECHNICAL
INFORMATION**

Please note that pages 37 - 43 include detailed information on the heights of the packets, the ratio of the number of cords and ladders to the width of the blind, as well as the full colour palette of tassels for operating cords.

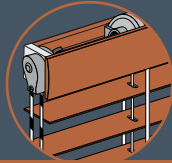
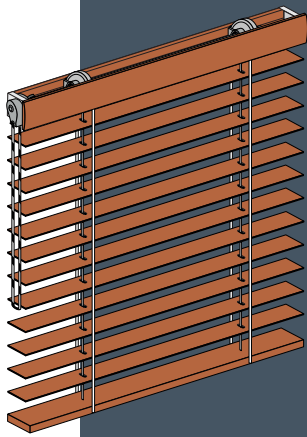

Side mounted mechanism

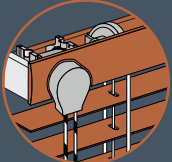

Front mounted mechanism

HJ 50-06
Mono-Cord

with an endless cord operation

- width: min. 0,35 m
max. 240 - 270 cm
(depending on the selected slat)
max. 3,60 m (slats: S-5020, S-5021 i S-5029)
max. 3 m - Abachi Collection
- height: min. 0,40 m
max. 3,50 m
- surface: max. recommended 4,00 m²
- operation: lifting - cord
rotating - cord

ADDITIONAL OPTIONS

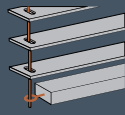

side guiding

page 19

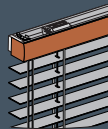

head rail cover
with sides

page 19

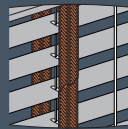

laddertape
25 / 38 mm

page 20

PROFILE

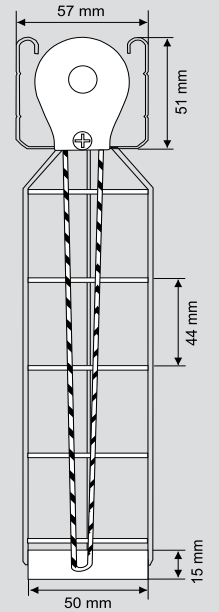

TYPES OF MOUNTING

STANDARD MOUNTING

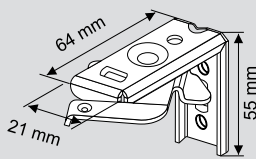

universal twist holder
(metal)

OPTIONAL MOUNTING

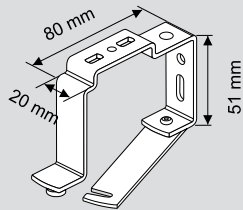

clamp
(with extra charge)

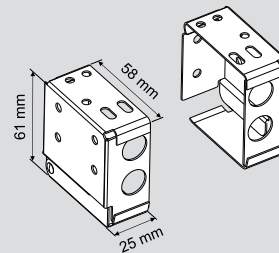

side mounting holder
(with extra charge)

MOUNTING THE BOTTOM RAIL

A bracket (zincplated steel) for fixing the bottom rail to prevent the venetian blind from moving when the window is tilted.

bottom rail bracket
(with extra charge)

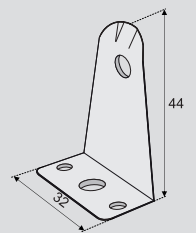

SPECIAL FORMS OF WOODEN BLINDS

Shadow-System also offers venetian blinds in special forms, although the production technology of these forms is quite complex. If you are interested in ordering such a blind, please contact our Customer Service. In order to confirm the possibility of manufacturing the required shape and obtaining a pricing, please send a technical drawing to us with all the dimensions and options which you would like to use in a given venetian blind.

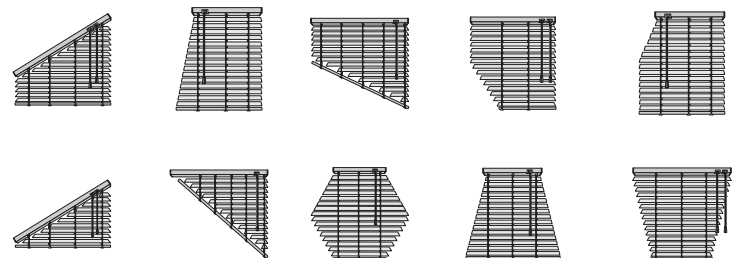



ADDITIONAL OPTIONS FOR WOODEN BLINDS 50 mm



Side guiding - This ensures holding the venetian blind in the plain of the window frame during opening or tilting. A steel line with a thickness of 1.2 mm in a perlon jacket goes through the holes at both ends of the wooden slats. The lines are tightened with tensioning springs in the head rail, and the bottom mounting holders are selected depending on the needs and mounting possibilities.

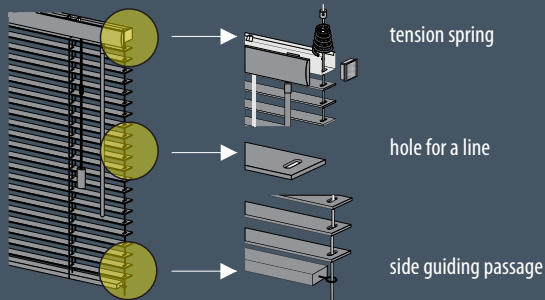

tension spring

hole for a line

side guiding passage



SIDE GUIDING

Mounting holders of side guiding

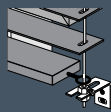

Holder made of steel for mounting on the wall or window frame.
Colour: zinc-plating

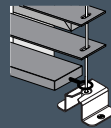
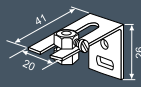

Holder made of steel for horizontal plain mounting.
Colour: zinc-plating

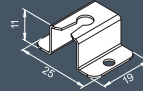

Angular holder made of transparent polycarbonate for horizontal plain mounting.

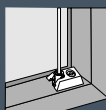
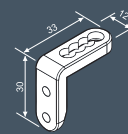

Holder made of transparent polycarbonate for mounting on the glazing bead.

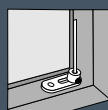
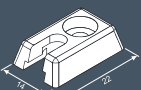

Holder made of steel, for mounting on the glazing bead.
Colours: white, grey, brown, black.

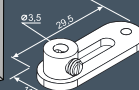

HEAD RAIL COVER WITH SIDES

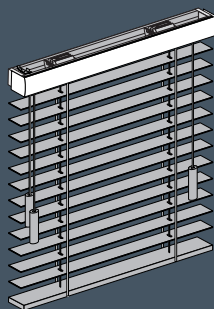

Head rail cover with sides - a standard head rail cover is additionally equipped with side endings mounted on side (R/L) or on both.

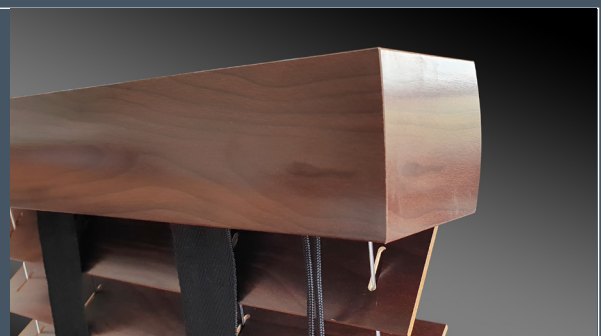



ADDITIONAL OPTIONS FOR WOODEN BLINDS 50 mm



LADDERTAPE

Laddertape - made of polyester and coloured with durable pigments, and subject to decatising in the production process, which guarantees low extensibility and high strength. Resistant to UV radiation, wearing and fading. A laddertape gives a better darkening effect by covering the holes in the slats through which a cord is placed for pulling up the blinds. A laddertape underlines the style of the blind perfectly.

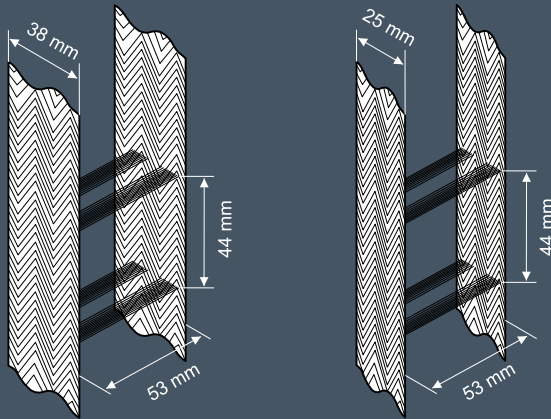

Laddertape 38 mm

Laddertape 25 mm

LADDERTAPE 25 mm

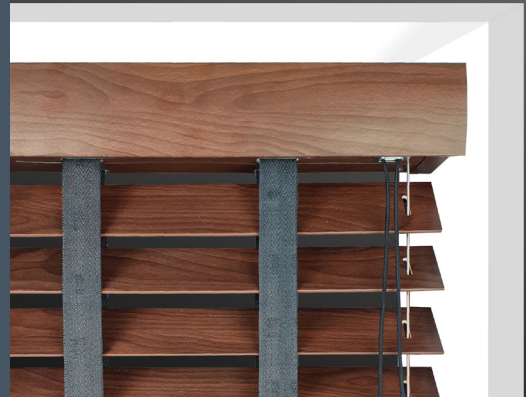

LADDERTAPE 38 mm

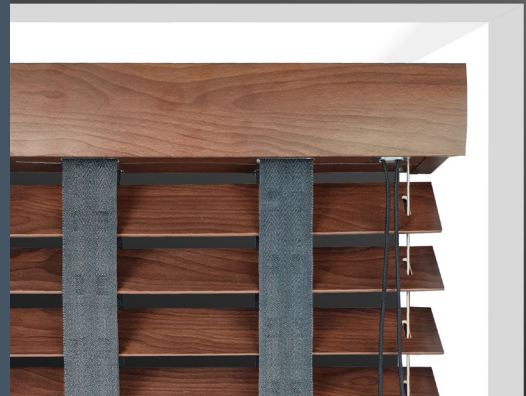

TASSELS FOR OPERATING CORDS

Tassels for an operating cords - there is an option to change standard operating tassel "sleeves" to either a "metal sleeve" for an extra charge, or a "wooden barrel" for free.



big „Barrel”

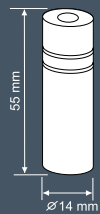

big „Wooden Sleeve”

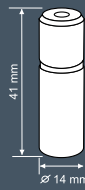

big „Metal Sleeve”

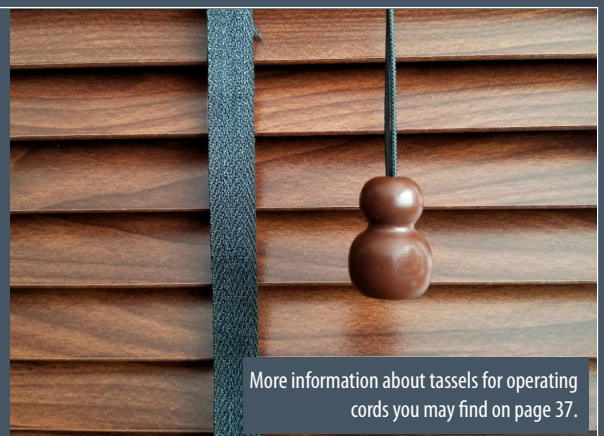

More information about tassels for operating cords you may find on page 37.

RETRO BLINDS - 50 mm

Retro blinds are the most exclusive and stylish type of venetian blinds. Their classical and timeless look can add charm and uniqueness to the interior. Retro blinds are produced only from slats with a width of 50 mm. It is possible to use both wooden slats and aluminium slats. The steel head rail is replaced with two wooden rails with exposed operating mechanisms, the rails matching the slat colour. The Retro blind has two available operating versions in the form of cord-cord and cord-wand.



Technical data:

Maximum dimensions: *	width 240 - 270 cm (depending on the selected slat) height 300 cm max. 3 m - Abachi Collection
Slat width:	50 mm
Slat thickness:	wooden slat 2 - 3 mm aluminium slat 0,21 - 0,24 mm
Recommended max. surface:	4,50 m ² *

* depending on the blind model and selected slat

Types of operation:

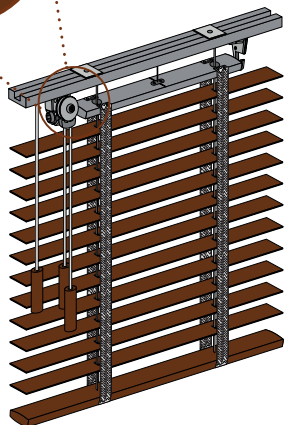
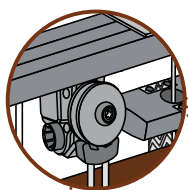

1. cord-cord

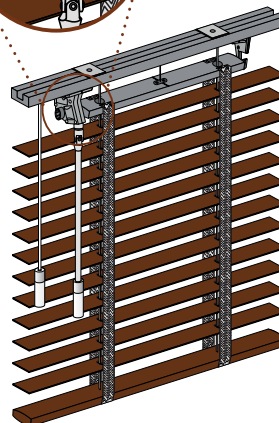
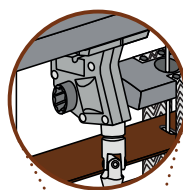

2. cord-wand

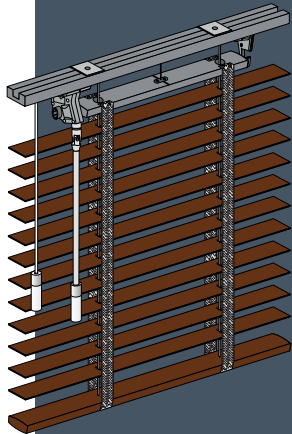

HJR 50-01
Retro blind

with a cord - wand operation

- width: min. 0,45 m
max. 2,70 m
- height: min. 0,40 m
max. 3,00 m
- surface: max. recommended 2,50 m²
- operation: lifting - cord
rotating - wand
- wand length: 1,2 m

Retro

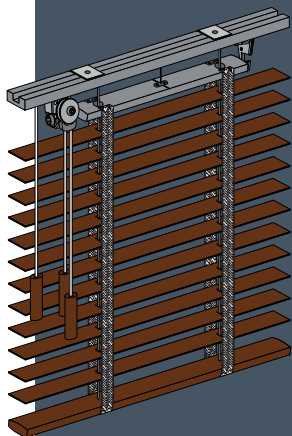

HJR 50-02
Retro blind

with cord - cord operation

- width: min. 0,45 m
max. 2,70 m
- height: min. 0,40 m
max. 3,00 m
- surface: max. recommended 3,50 m²
- operation: lifting - cord
rotating - cord

Retro

TEXTILE

Retro blinds standardly have laddertape with a width of 25 mm. It is possible to equip the blinds with laddertape, with a width of 38 mm, free of charge.

PROFILE

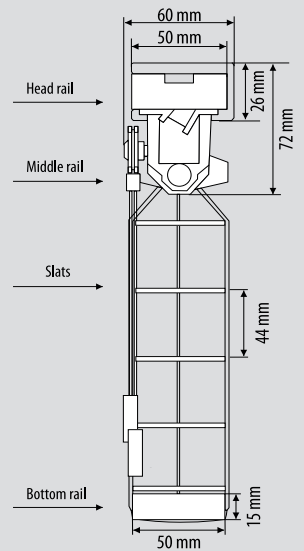
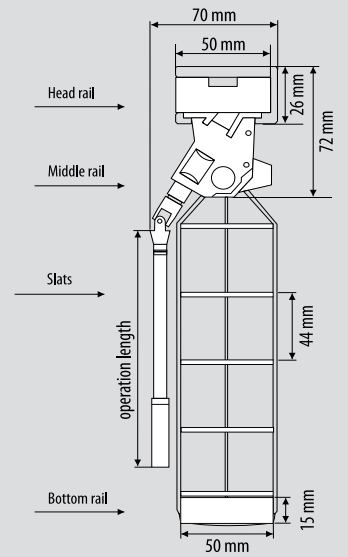

TYPES OF MOUNTING

STANDARD MOUNTING

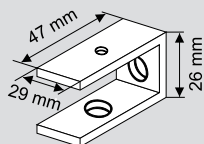

universal holder

TYPE „C“

OPTIONAL MOUNTING

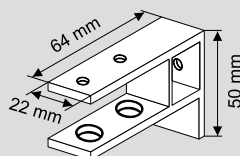

angular holder
(with extra charge)

TYPE „F“

PROFILE

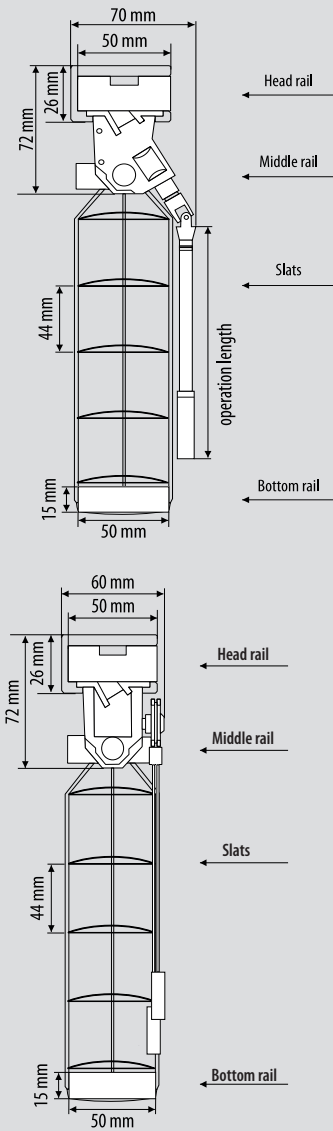

Retro

**AJR 50-01
Retro blind**

with a cord-wand operation

- width: min. 0,45 m
max. 2,70 m
- height: min. 0,40 m
max. 3,00 m
- surface: max. recommended 3,50 m²
- operation: lifting - cord
rotating - wand
- wand length: 1,2 m

Retro

**AJR 50-02
Retro blind**

with cord - cord operation

- width: min. 0,45 m
max. 2,70 m
- height: min. 0,40 m
max. 3,00 m
- surface: max. recommended 4,50 m²
- operation: lifting - cord
rotating - cord

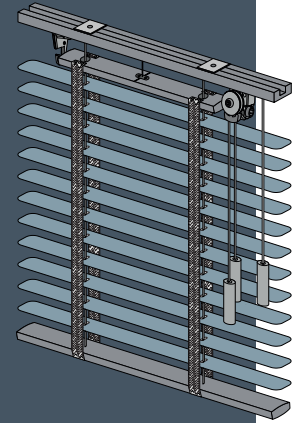
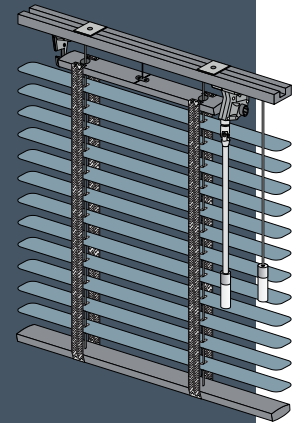

ALUMINIUM SLATS

RETRO
BLINDS

TEXTILE

Retro blinds typically have laddertapes with a width of 25 mm. It is possible to equip the blinds with ladders, with a width of 38 mm, free of charge.



Colours of aluminium slats you can find in our collection book of horizontal blinds.

COLOUR

TASSELS FOR AN OPERATING CORDS



Wooden Sleeve
STANDARD



Wooden Barrel
OPTIONAL
NO EXTRA CHARGE



Metal Sleeve
OPTIONAL
WITH EXTRA CHARGE

RETRO MECHANISM
AVAILABLE COLOURS

cord-cord

- white
- black
- silver
- brass

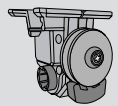

cord-wand

- brass

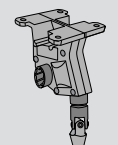



ALUMINIUM BLINDS

Aluminium blinds are a perfect choice for modern and industrial interiors. The rich colour choice of slats with various paint coat options will enable the ideal matching of blinds with the nature of a given room. The mechanism and possible operating variants for aluminium blinds are exactly the same as in wooden blinds – the only difference is the material used to make slats. Aluminium blinds are characteristic for their high resistance to UV radiation and total resistance to biological factors and humidity; therefore, an aluminium blind would also be a good choice for kitchens and bathrooms. Aluminium tapes – which are used for producing horizontal blinds – are available with a thickness range from 0.21 mm to 0.24 mm. This is the thickest tape available on the market which is characteristic for exceptional durability.

Slat widths available

16 mm

25 mm

50 mm

SAMPLES



SMOOTH, MATT
SLAT

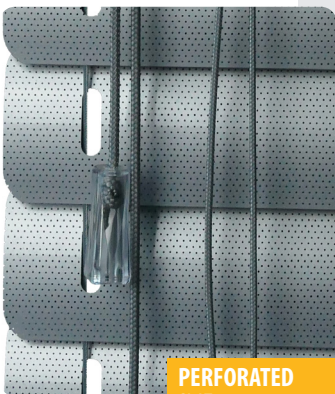

PERFORATED
SLAT

IN THE ALUMINIUM BLINDS SYSTEM INCLUDING SLATS WITH DIFFERENT COATING OPTIONS



Smooth, high-gloss lacquered tape



Smooth, matt tape

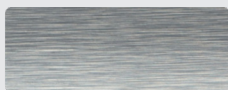

Brushed aluminum effect tape



Velvet-structured ribbon in pastel colours



Tape with a metallized coating to improve light reflection

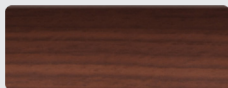

Tape with a pattern imitating the structure of wood

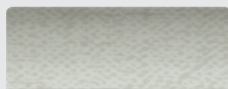

Patterned tape



The tape is varnished in two different colours on opposite planes



Perforated tape

ALUMINIUM BLINDS - 25 / 16 mm

Aluminium blinds 25 mm are one of the most popular blinds on the market. A wide range of over 120 colours and a compact system that gives many installation options, including non-invasive on the window frame, makes the aluminum blind with 25 mm slat a universal matching solution practically for every interior and most windows.

The aluminium blinds with slat 16 mm use the same head and bottom rails as the 25 mm blinds. However, due to a smaller width of the slats, the 16 mm blinds are intended to small interiors and to cover small-sized window . We offer 16 mm slats in the 10 most popular colours. All 16 and 25 mm slats in ours collections come from a renowned Swedish manufacturer, by OPL.



Technical data:

Maximum dimensions:	width 300 cm for blind 25 mm *
	width 250 cm for blind 16 mm *
	height 300 cm *
Slat width:	25 mm
Slat thickness:	0,21 mm
Recommended max. surface:	6,00 m ² *
Colours:	according to the current collection of aluminium slats

* depending on the blind model

Types of operation:

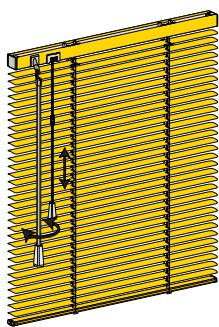

1. cord - wand

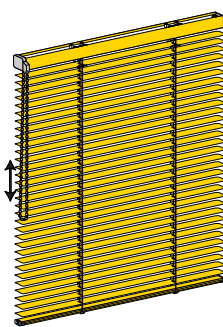

2. endless chain

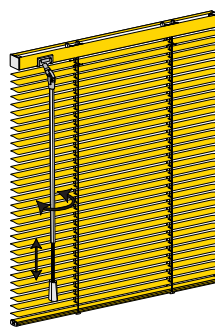

3. monomagic
(cord integrated
with wand)

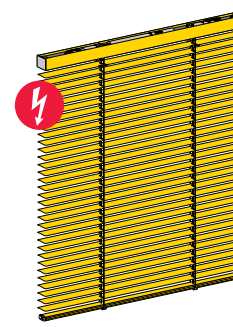

4. motor

Motors for aluminium blinds 25 / 16 mm:

LW25 B83



somfy.

The motor with the nominal torque of 0.8 Nm. Installed centrally, with an embedded brake and overload limiter. The motor design ensures a silent and reliable operation.

TILT&LIFT 25 RTS



somfy.

The motor suitable for 12 V voltage – battery power supply with an option of using a solar panel or by means of a plug-in AC power adapter. Controlled with an RTS radio signal.

More technical information on motors on pages 44 - 53

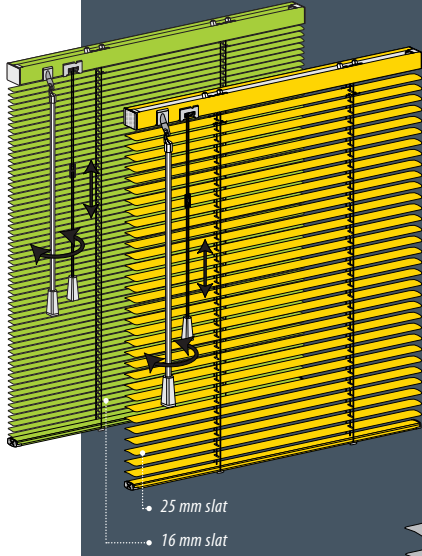

AJ 25-01 / AJ 16-01
Standard blind

with a cord-wand operation

	25 mm	16 mm
width:	min. 0,30 m	0,30 m
	max. 3,00 m	2,00 m
height:	min. 0,30 m	0,30 m
	max. 3,00 m	3,00 m
recommended surface:	max. 5,00 m ²	5,00 m ²
operation:	lifting - cord rotating - wand	

ADDITIONAL OPTIONS

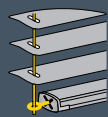

side guiding

page 29

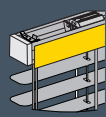

head rail wooden cover

page 29

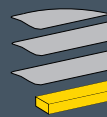

wooden bottom rail

page 29



mechanism covers

page 28



BLACKOUT
(blinds 25 mm only,
without side guiding)

page 30



mix of colours

page 30

• 25 mm slat
• 16 mm slat

PROFILE

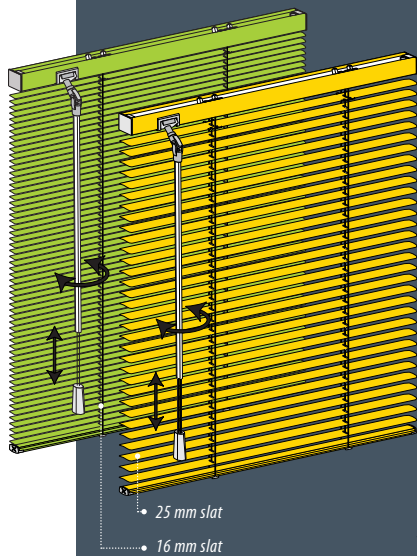
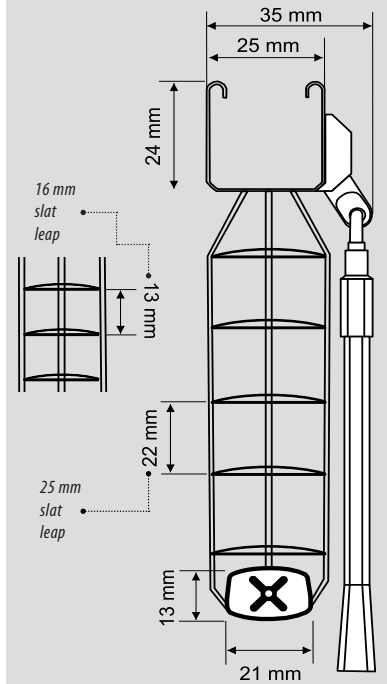

AJ 25-02 / AJ 16-02
Monomagic blind

with a cord integrated with wand operation

	25 mm	16 mm
width:	min. 0,30 m	0,28 m
	max. 1,20 m	1,20 m
height:	min. 0,30 m	0,45 m
	max. 2,50 m	2,50 m
recommended surface:	max. 2,50 m ²	2,50 m ²
operation:	lifting - cord rotating - wand	

ADDITIONAL OPTIONS

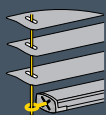

side guiding

page 29

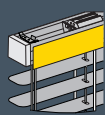

head rail wooden cover

page 29

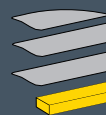

wooden bottom rail

page 29



mechanism covers

page 28

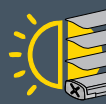

BLACKOUT
(blinds 25 mm only,
without side guiding)

page 30



mix of colours

page 30

• 25 mm slat
• 16 mm slat

PROFILE

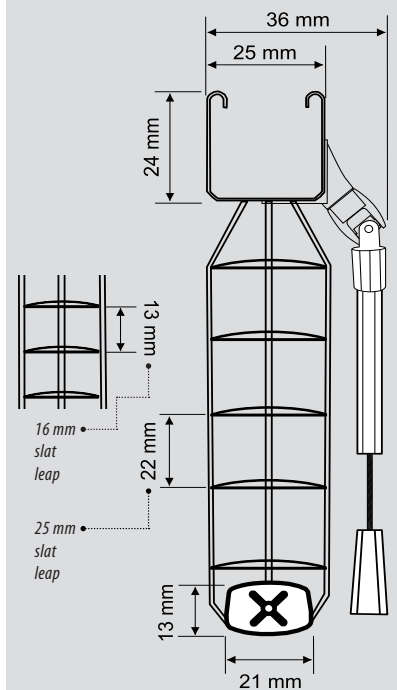

PROFILE

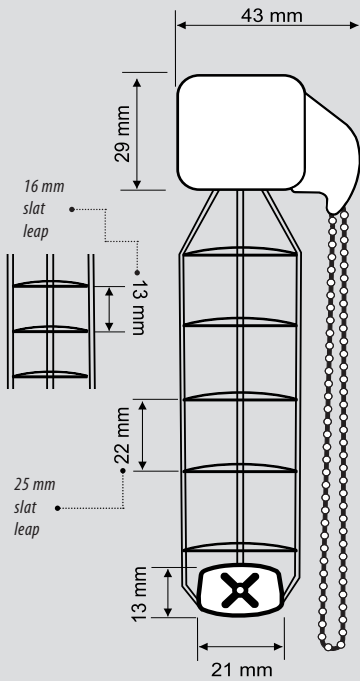

AJ 25-03 / AJ 16-03
Mono chain blind

with an endless chain operation

	25 mm	16 mm
width:	min. 0,30 m	0,30 m
	max. 2,80 m	2,00 m
height:	min. 0,30 m	0,30 m
	max. 2,50 m	2,50 m
recommended surface:	max. 4,00 m ²	4,00 m ²
operation:	lifting - chain	
	rotating - chain	

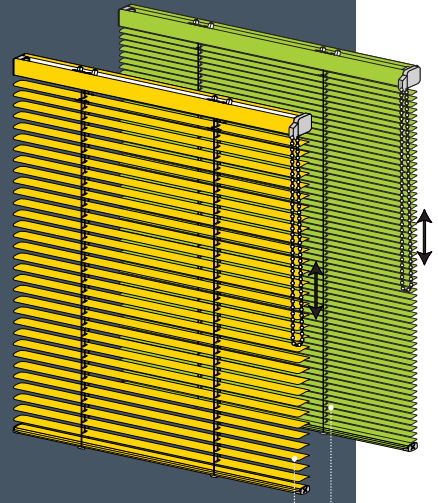

COLOURS OF MECHANISMS

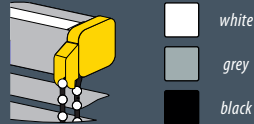

COLOURS OF CHAIN



METAL CHAIN WITH EXTRA CHARGE



ADDITIONAL OPTIONS

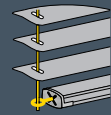

side guiding
page 29

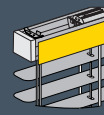

head rail wooden cover
page 29

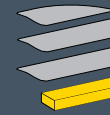

wooden bottom rail
page 29

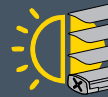

BLACKOUT
(blinds 25 mm only,
without side guiding)
page 30



mix of colours
page 30

25 mm slat
16 mm slat

PROFILE

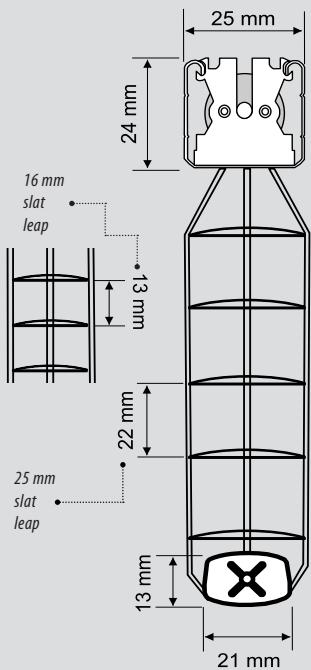

AJ 25-05 / AJ 16-05
Motor operated blind

	25 mm	16 mm
width:	min. 0,55 m	0,55 m
	max. 3,00 m	2,00 m
height:	min. 0,50 m	0,50 m
	max. 3,00 m	3,00 m
recommended surface:	max. 5,00 m ²	6,00 m ²
operation:	electric motor	

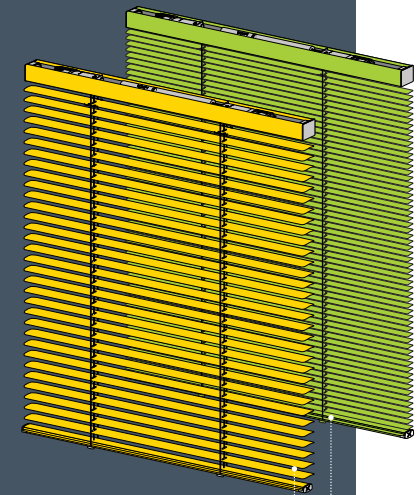

ADDITIONAL OPTIONS

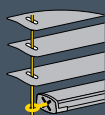

side guiding
page 29

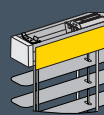

head rail wooden cover
page 29

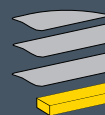

wooden bottom rail
page 29



BLACKOUT
(blinds 25 mm only,
without side guiding)
page 30



mix of colours
page 30

25 mm slat
16 mm slat

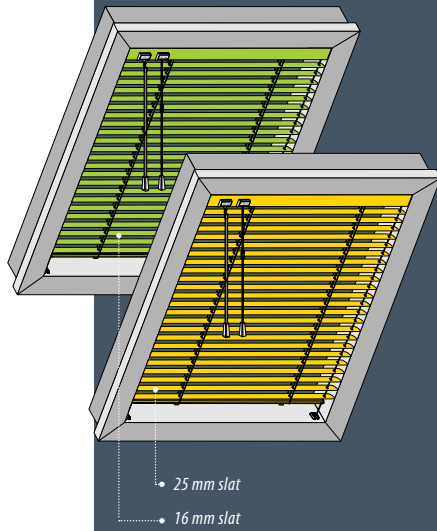

AJ 25-01D / AJ 16-01D
Roof blind

with a cord-wand operation

		25 mm	16 mm
width:	min.	0,30 m	0,28 m
	max.	1,00 m	1,00 m
height:	min.	0,30 m	0,45 m
	max.	1,30 m	1,30 m
recommended surface:	max.	1,00 m ²	1,00 m ²
operation:	lifting - cord		
	rotating - wand		

ADDITIONAL OPTIONS

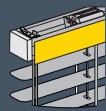

head rail
wooden cover
page 29

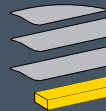

wooden bottom rail
page 29

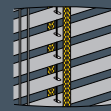

laddertape
(blinds 25 mm only)
page 30



mix of colours
page 30

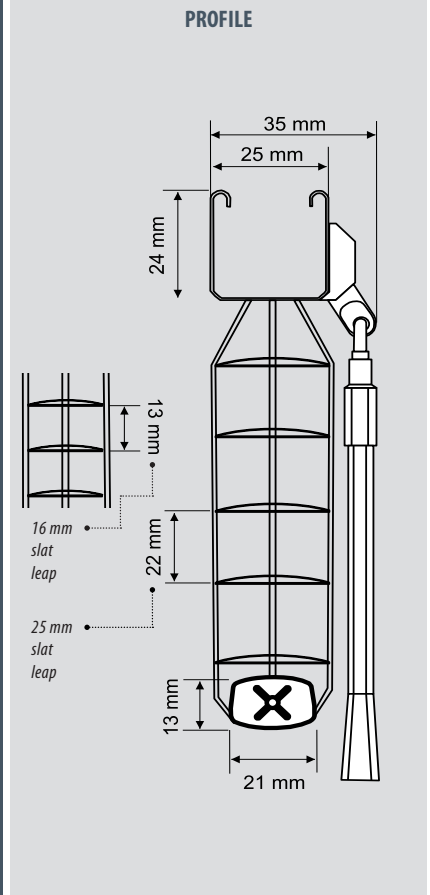

! The roof blinds are equipped with side guiding as standard. The minimum inclination angle of the roof is 35°



ADDITIONAL OPTIONS FOR ALUMINIUM BLINDS 25 i 16 mm



MECHANISM COVERS

Mechanism covers - These are decorative covers that improve the product aesthetics, cover the mechanism of the wand, and the operating cords of the blind. The covers are made of polycarbonate and are available in two colours – transparent and anthracite.

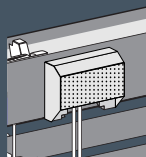

Covers of mechanisms to
lifting and rotating

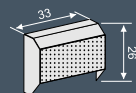



ADDITIONAL OPTIONS FOR ALUMINIUM BLINDS 25 i 16 mm



HEAD RAIL
WOODEN COVER

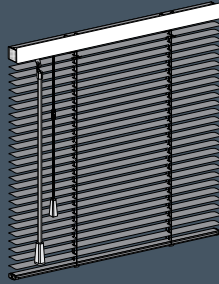

Head rail wooden cover – this is an additional decorative cover that is mounted directly to the head rail by means of special holders. The covering panel is made of wood that matches, as close as possible, the colour of the blind aluminium slats. It is also possible to choose a different colour. In addition, the front cover may be equipped with side covers on one side or two sides.

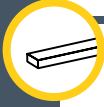

WOODEN
BOTTOM RAIL

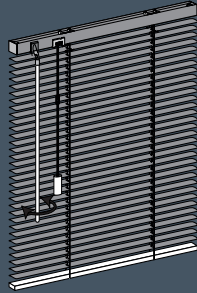

Wooden bottom rail - it is possible to replace the steel bottom rail with a wooden rail matching the colour of the slats, or in a different colour selected by the customer. Together with the wooden head rail cover, it would be an interesting decorative addition to the aluminium blind.



SIDE GUIDING

Side guiding - This ensures holding the blind in the plain of the window frame during opening or tilting. A steel line with the thickness of 1.2 mm in a perlon jacket goes through the holes on both ends of the aluminium slats. The lines are tightened with tensioning springs in the upper blind rail, and the bottom mounting holders are selected depending on the needs and mounting possibilities.

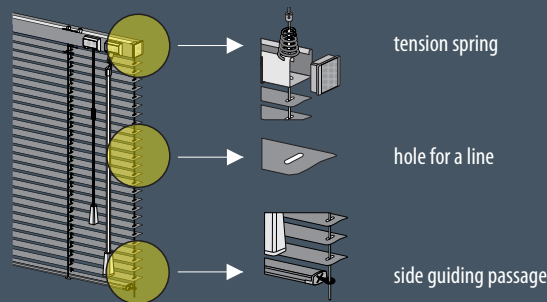

Mounting holders of side guiding

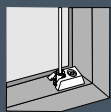

Holder made of transparent polycarbonate, mounting on the glazing bead.

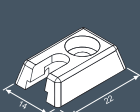

Angular holder made of transparent polycarbonate, for mounting on the window frame.

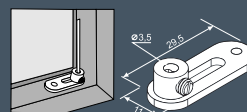
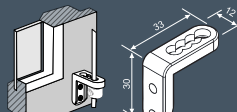

Holder made of painted steel, for mounting on the glazing bead. Colours: white, grey, brown, black.

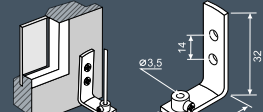

Angular holder made of zinc plated steel, for mounting on the window frame.



ADDITIONAL OPTIONS FOR ALUMINIUM BLINDS 25 i 16 mm



LADDERTAPE 12 MM

Laddertape 12 mm - made of polyester and coloured with durable pigments. Subject to decatising in the production process, which guarantees low extensibility and high strength. Resistant to UV radiation, wearing and fading. A laddertape gives a better shading effect by covering the holes in the slats through which a cord is placed for pulling up the blinds. A laddertape emphasizes the style of the blind perfectly.

For blinds 25 mm with a cord - wand operation only.

Use of a 12 mm laddertape in the blind 25 mm limits the possibility blind fully closed.

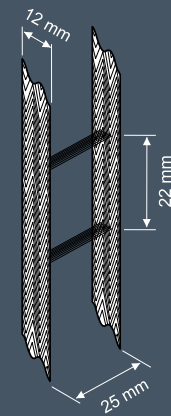

laddertape 12 mm



BLACKOUT

BLACKOUT blind - Owing to ladders with a smaller stroke (18 mm) in relation to standard blinds (22 mm), it limits the clearance when in the closed position. In addition, thanks to shifting the holes, cords used for pulling up the blinds are not visible in this position which improves the visual effect.

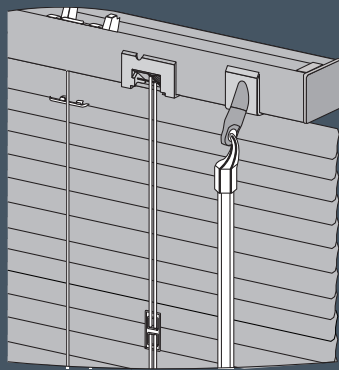

Standard

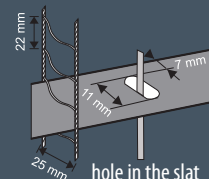

hole in the slat of standard blind

BLACKOUT

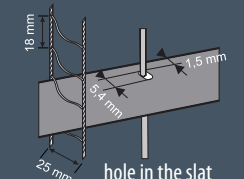

hole in the slat of BLACKOUT blind



MIX OF COLOURS

Personalised colours – We offer the possibility of playing with colours through the choice of any 5 colours of aluminium slats in one blind.

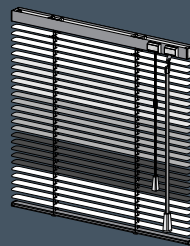

TYPES OF MOUNTING

STANDARD MOUNTING

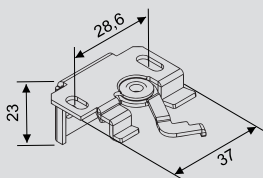

universal twist holder

OPTIONAL MOUNTING

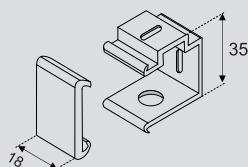

plastic clamp (with extra charge)

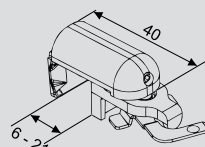

non-invasive block holder (with extra charge)

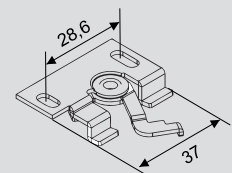

ceiling twist holder (no extra charge)

ALUMINIUM BLINDS - 50 mm

Aluminium blinds 50 mm - An ideal product that enables the covering of large window surfaces, which at the same time functions as a modern interior decoration. We offer 50 mm aluminium blinds in a few operating variants: cord-cord, mono chain, endless cord and increasingly popular versions with an motor, including battery motors. 50 mm width slats may be used in the RETRO system, combining the classical system style and wooden accessories with modern aluminium.



Technical data:

Maximum dimensions: *	width 450 cm height 500 cm
Slat width:	50 mm
Slat thickness:	0,21 - 0,24 mm
Recommended max. surface:	16,00 m ² *
Colours:	according to the current collection of aluminium slats

* depending on the blind model

Types of operation:

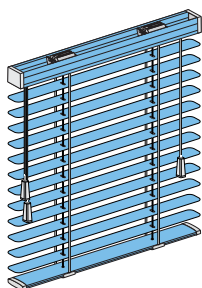

1. cord - cord

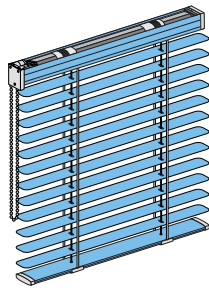

2. endless chain

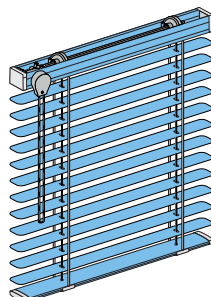

3. endless cord

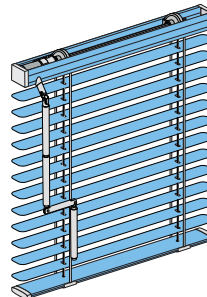

4. crank

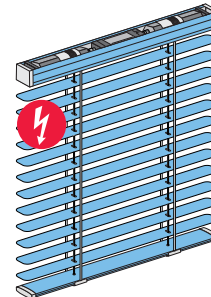

5. motor

Electric motors for aluminium blinds 50 mm:

Sonesse 40 PA / RTS



Compact and silent motor supplied with 230 V. Operation below 45 dB. Nominal torque from 3 Nm to 9 Nm depending on the model selected. Controlled by means of a cable (PA), radio (RTS) or radio by means of io-homecontrol (io) technology.

BREL BLE 35



The motor is supplied with an integrated multiple charging battery, with a nominal torque of 10 Nm. Operated by means of a remote control device or wall switch.

J4 WT / RTS



The motor for heavy wooden blinds, ensuring the stable and uniform pulling-up of slats. J4 series engines are louder than Sonesse motors and are used only at the customer's request in exceptional installation conditions.

More technical information on motors on pages 44 - 53

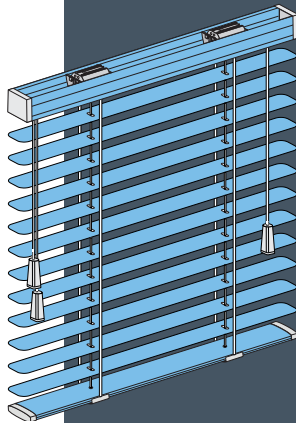

AJ 50-02
Standard blind
 Cord operated blind

width: min. 0,35 m
 max. 4,50 m
 height: min. 0,40 m
 max. 4,50 m
 surface: max. recommended 10,00 m²
 operation: lifting - cord
 rotating - cord

ADDITIONAL OPTIONS

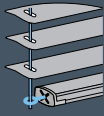

side guiding
 page 35

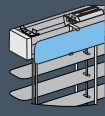

head rail aluminium cover
 page 35

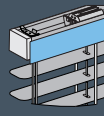

head rail wooden cover
 page 36

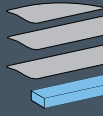

bottom wooden rail
 page 36

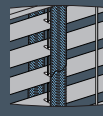

laddertape 25 / 38 mm
 page 36



mix of colours
 page 35

PROFILE

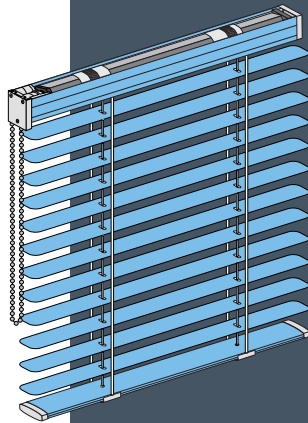
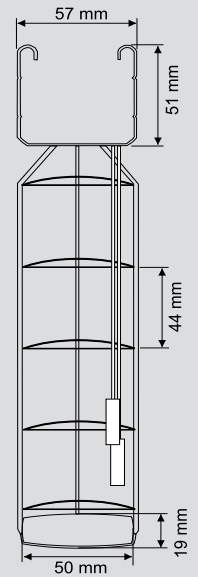

AJ 50-03
Mono chain blind
 with an endless chain operation

width: min. 0,40 m
 max. 3,00 m
 height: min. 0,40 m
 max. 3,00 m
 surface: max. recommended 8,00 m²
 operation: lifting - chain
 rotating - chain

ADDITIONAL OPTIONS

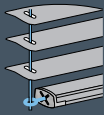

side guiding
 page 35

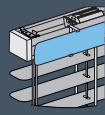

head rail aluminium cover
 page 35

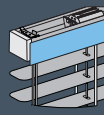

head rail wooden cover
 page 36

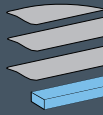

bottom wooden rail
 page 36

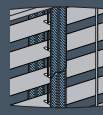

laddertape 25 / 38 mm
 page 36



mix of colours
 page 35

PROFILE

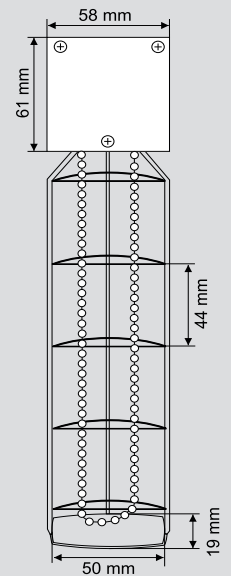

COLOURS OF CHAIN

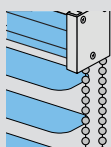

PVC CHAIN - STANDARD

- white
- black
- grey
- brown

METAL CHAIN - WITH EXTRA CHARGE

- chrome

MECHANISM COVER COLOURS

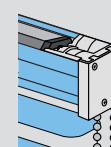

- white
- off white
- grey
- gold oak
- black

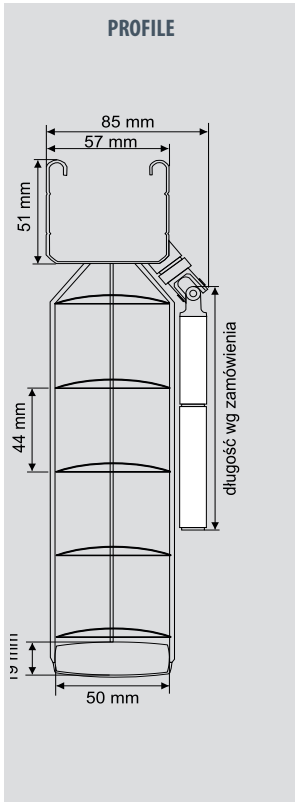

AJ 50-04
Crank operated blind

width: min. 0,40 m
max. 4,50 m
height: min. 0,40 m
max. 4,50 m
surface: max. recommended 7,00 m²
operation: lifting - crank
rotating - crank
crank length: max. 4,00 m

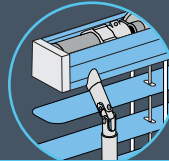

Fixed crank

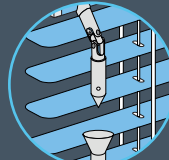

Detachable crank

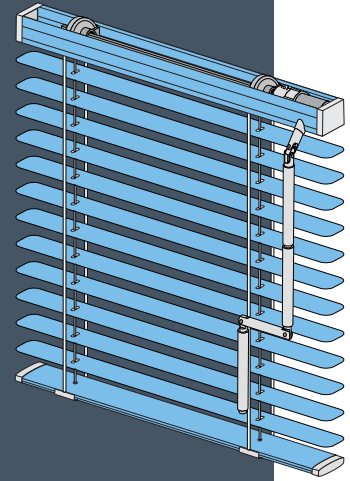

ADDITIONAL OPTIONS

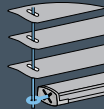

side guiding

page 35

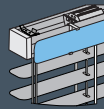

head rail
aluminium cover

page 35

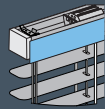

head rail
wooden cover

page 36

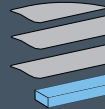

bottom
wooden rail

page 36

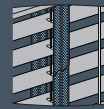

laddertape
25 / 38 mm

page 36



mix of colours

page 35

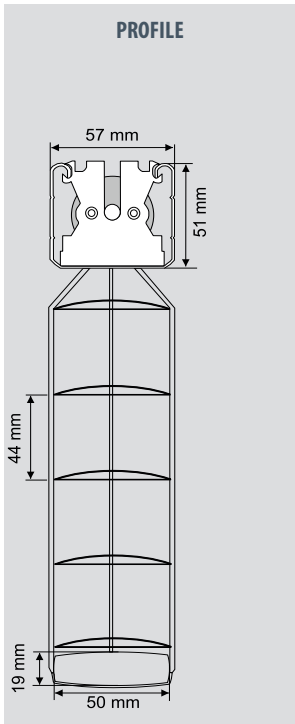

AJ 50-05
Motor operated blind

width: min. 0,65 m
max. 4,50 m
height: min. 0,50 m
max. 5,00 m
surface: max. recommended 16,00 m²
operation: lifting - electric motor
rotating - electric motor

ADDITIONAL OPTIONS

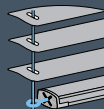

side guiding

page 35

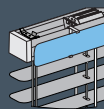

head rail
aluminium cover

page 35

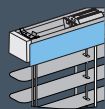

head rail
wooden cover

page 36

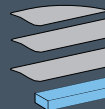

bottom
wooden rail

page 36

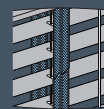

laddertape
25 / 38 mm

page 36



mix of colours

page 35

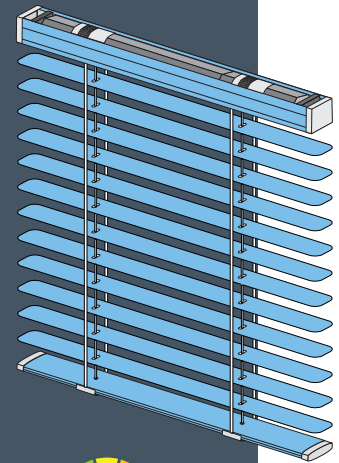

**TECHNICAL
INFORMATION**

Please note that pages 37 - 43 include detailed information on the heights of the packets, the ratio of the number of cords and ladders to the width of the blind, as well as the full colour palette of tassels for operating cords.

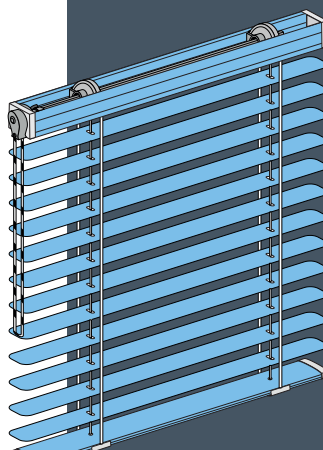

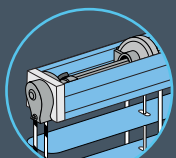

Side mounted mechanism

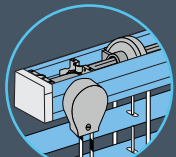



Front mounted mechanism

AJ 50-06
Mono cord blind
 with endless cord operation

width: min. 0,35 m
 max. 3,00 m
 height: min. 0,40 m
 max. 3,00 m
 surface: max. recommended 8,00 m²
 operation: lifting - cord
 rotating - cord

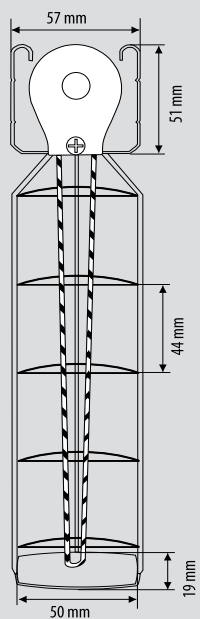
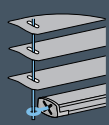
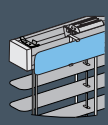
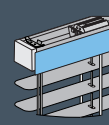
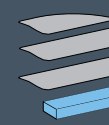
ADDITIONAL OPTIONS

					
side guiding	head rail aluminium cover	head rail wooden cover	bottom wooden rail	laddertape 25 / 38 mm	mix of colours
page 35	page 35	page 36	page 36	page 36	page 35

PROFILE



57 mm
 51 mm
 44 mm
 19 mm
 50 mm

TYPES OF MOUNTING

STANDARD MOUNTING

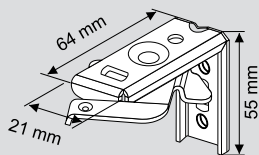

universal twist holder (metal)

OPTIONAL MOUNTING

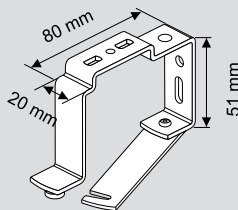

clamp (with extra charge)

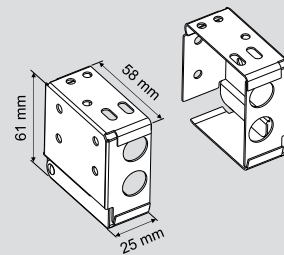

side mounting holder (with extra charge)

SPECIAL FORMS OF WOODEN BLINDS

Shadow-System also offers venetian blinds in special forms, although the production technology of these forms is quite complex. If you are interested in ordering such a blind, please contact our Customer Service. In order to confirm the possibility of manufacturing the required shape and obtaining a pricing, please send a technical drawing to us with all the dimensions and options which you would like to use in a given venetian blind.

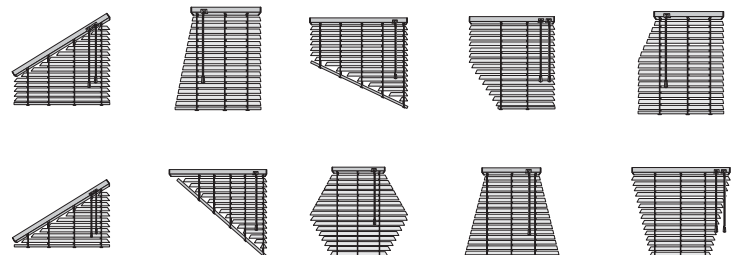



ADDITIONAL OPTIONS ALUMINIUM BLINDS 50 mm



HEAD RAIL ALUMINIUM COVER

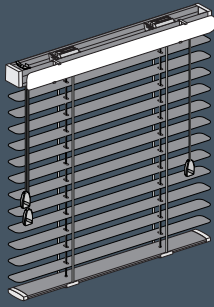

Head rail aluminium cover - This is an additional cover that is mounted directly to the upper rail by means of special holders. The covering panel is made from the same slat as the blind. It is also possible to make a cover panel from a different slat selected by the customer.



SIDE GUIDING

Side guiding - This ensures holding the blind in the plain of the window frame during opening or tilting. A steel line with a thickness of 1.2 mm in a perlon jacket goes through the holes on both ends of the aluminium slats. The lines are tightened with tensioning springs in the upper blind rail, and the bottom mounting holders are selected depending on the needs and mounting possibilities.

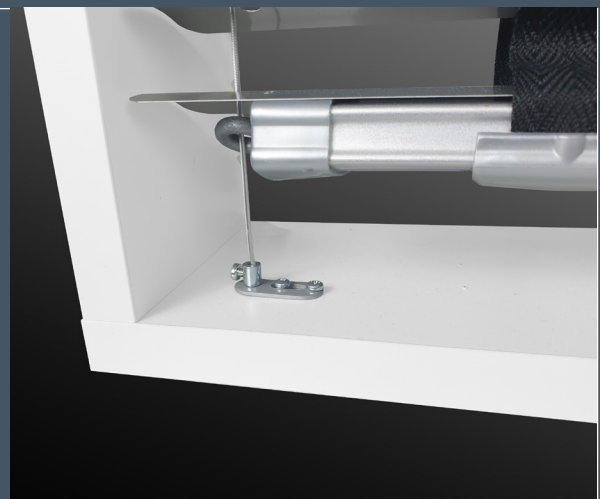
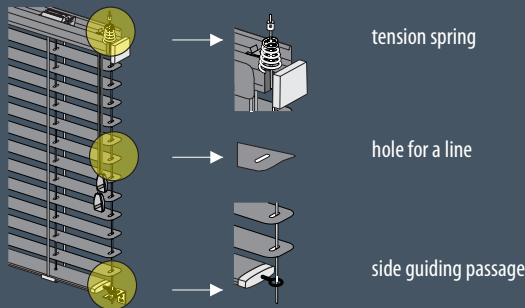

Mounting holders of side guiding

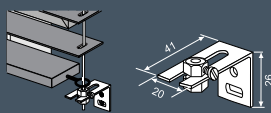

Holder made of zinc plated steel, for mounting on the wall or window frame.
Colour: zinc-plating.

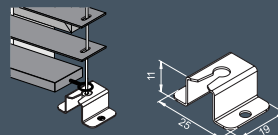

Holder made of zinc plated steel, for horizontal plain mounting.

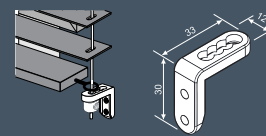

Holder made of transparent polycarbonate, for mounting on the wall or the window frame.

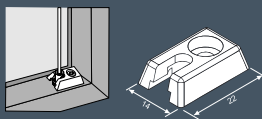

Holder made of transparent polycarbonate, for mounting on the glazing bead.

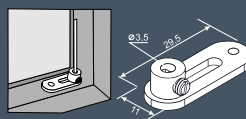

Holder made of painted steel, for mounting on the glazing bead.
Colours: white, grey, brown, black.



MIX OF COLOURS

Personalised colours - We offer the possibility of playing with colours through the arbitrary choice of using a maximum of 5 colours of aluminium slats in one blind.

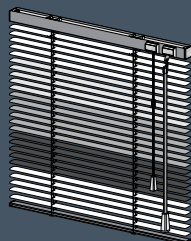



ADDITIONAL OPTIONS ALUMINIUM BLINDS 50 mm



HEAD RAIL
WOODEN COVER

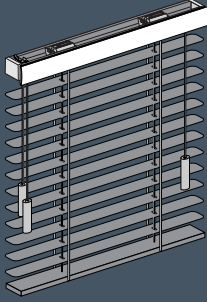

Head rail wooden cover - This is an additional decorative cover that is mounted directly to the upper rail by means of special holders. The head rail cover is made of wood that is matching, as close as possible, the colour of the blind aluminium slats. In addition, the covering panel may be equipped with side finishing mounted on one side or two sides.



WOODEN
BOTTOM RAIL

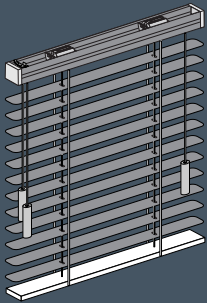

Wooden bottom rail - It is possible to replace the steel bottom rail with a wooden rail matching the colour of the slats. Together with the wooden head rail cover, it would be an interesting decorative addition to the aluminium blind.



LADDERTAPE

Laddertape - made of polyester. This is coloured with permanent pigments which are as close as possible to the slat colour or patterned. Subject to decatising in the production process which guarantees low extensibility and high strenght. Resistant to UV radiation, wearing and fading. A laddertape gives a better darkening effect by covering the holes in the slats through which a cord is placed for pulling up the blind pack. A laddertape underlines the style of the blind perfectly.

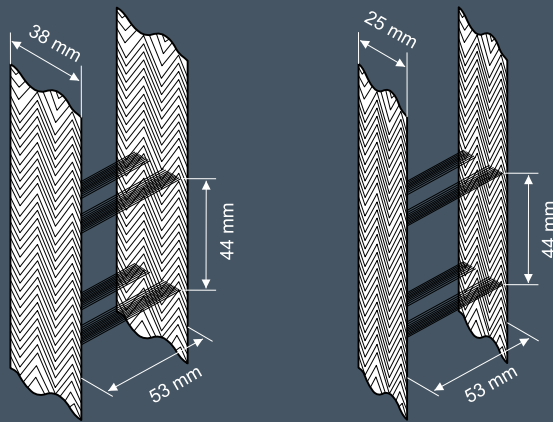

laddertape 38 mm

laddertape 25 mm

LADDERTAPE 25 mm



LADDERTAPE 38 mm





COLOURS OF WOODEN AND METAL ACCESSORIES

In order to satisfy our customers' expectations and to follow changing stylistic / colour trends, we enable total personalisation of a final product. Interior designers combine the accessories' colours, giving the decorated interiors originality. The elements whose colours may be modified freely are:

- TASSELS FOR OPERATING CORDS
- LADDERCORD / LADDERTAPE
- OPERATING CORDS
- HEAD RAIL COVER / HEAD RAIL COVER WITH SIDES

In order to make such a modification, insert a colour of a given element, consistent with the current Shadow-System pattern book on the order form in the proper column. If there is no such information, it means that the customer wants a given element to have a colour that is matching the colour of the selected slat

TASSELS FOR OPERATING CORDS



THE BARREL

The Barrel – tassel for operating cord made of wood.

For wooden and aluminium blinds 50 mm.

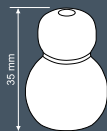

For wooden blinds 25 mm and aluminium blinds 25/16 mm.

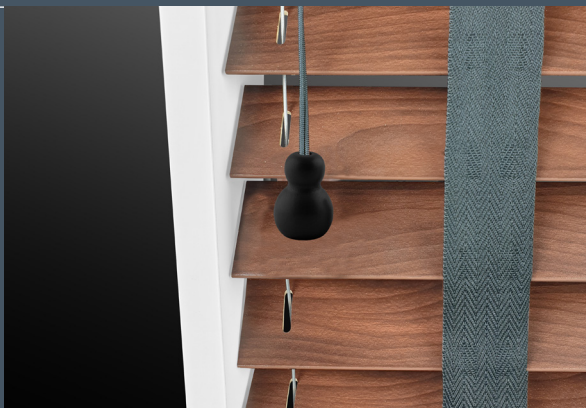
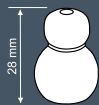

THE WOODEN SLEEVE

The Wooden Sleeve – tassel for operating cord made of wood.

For wooden and aluminium blinds 50 mm.

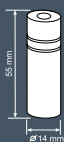

For wooden blinds 25 mm and aluminium blinds 25/16 mm.

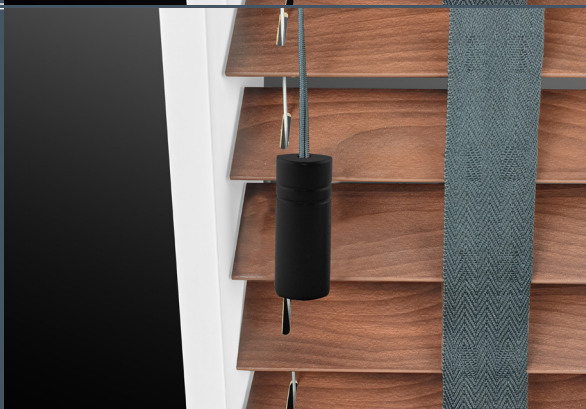

THE METAL SLEEVE

The Metal Sleeve – tassel for operating cord made of steel.

For wooden and aluminium blinds 50 mm.

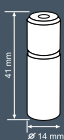

For wooden blinds 25 mm and aluminium blinds 25/16 mm.

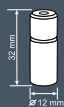



PACKAGE HEIGHT

BLIND PACKAGES - WHAT ARE THESE?

The tables provided below specify the height of the package of the pulled-up blind. The values are divided into cord or laddertape types. These have to be taken into consideration when the blind is mounted over the window, and which can be opened fully or over the balcony doors. There is no suggested size of the header and its height depends on the original assumptions of the designers. Therefore, in order to avoid a situation in which the mounted blind limits the opening of window/balcony frames, it is necessary to refer to the tables provided below. There is a separate table for RETRO blinds.

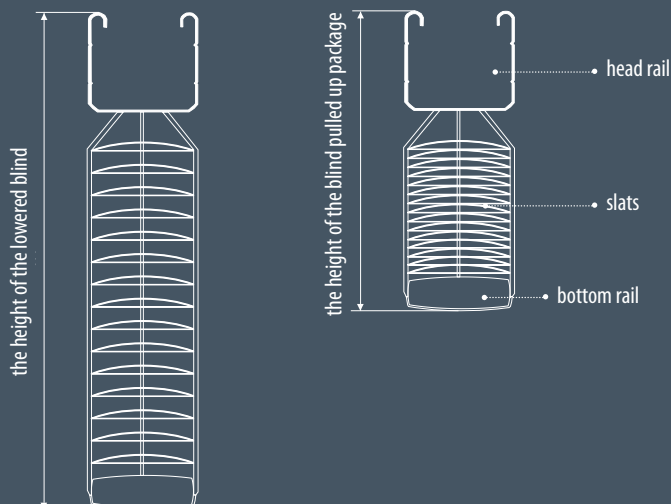

ALUMINIUM BLINDS:

ALUMINIUM BLINDS 25 mm

BLIND'S HEIGHT	PACKAGE HEIGHT [CM] *	
	LADDERCORD	LADDERTAPE
50	8 cm	9 cm
100	9 cm	10 cm
150	10 cm	11 cm
200	11 cm	13 cm
250	12 cm	15 cm
300	13 cm	17 cm

ALUMINIUM BLINDS 16 mm

BLIND'S HEIGHT	PACKAGE HEIGHT [CM] *	
	LADDERCORD	LADDERTAPE
50	8 cm	-
100	9 cm	-
150	11 cm	-
200	12 cm	-
250	14 cm	-
300	15 cm	-

ALUMINIUM BLINDS 50 mm

BLIND'S HEIGHT	PACKAGE HEIGHT [CM] *	
	LADDERCORD	LADDERTAPE
50	11 cm	12 cm
100	12 cm	14 cm
150	13 cm	15 cm
200	14 cm	17 cm
250	15 cm	19 cm
300	16 cm	21 cm
350	17 cm	23 cm

ALUMINIUM RETRO BLINDS 50 mm

BLIND'S HEIGHT	PACKAGE HEIGHT [CM] *	
	LADDERCORD	LADDERTAPE
50	-	13 cm
100	-	16 cm
150	-	19 cm
200	-	22 cm
250	-	25 cm
300	-	27 cm
350	-	30 cm



* together with the head rail and bottom rail



PACKAGE HEIGHT

WOODEN BLINDS:

WOODEN BLINDS 25 mm

BLIND'S HEIGHT	PACKAGE HEIGHT [CM] *	
	LADDERCORD	LADDERTAPE
50	13 cm	14 cm
100	19 cm	20 cm
150	25 cm	27 cm
200	31 cm	34 cm
250	38 cm	41 cm
300	44 cm	48 cm
350	50 cm	55 cm

There is also a separate table for RUSTIC slats which are thicker than the slats in other collections.

WOODEN BLINDS 50 mm

BLIND'S HEIGHT	PACKAGE HEIGHT [CM] *	
	LADDERCORD	LADDERTAPE
50	13 cm	14 cm
100	17 cm	18 cm
150	20 cm	23 cm
200	24 cm	28 cm
250	27 cm	32 cm
300	31 cm	37 cm
350	35 cm	41 cm

WOODEN BLINDS 50 mm RUSTIC

BLIND'S HEIGHT	PACKAGE HEIGHT [CM] *	
	LADDERCORD	LADDERTAPE
50	14 cm	15 cm
100	18 cm	20 cm
150	22 cm	25 cm
200	26 cm	30 cm
250	30 cm	35 cm
300	34 cm	40 cm
350	39 cm	45 cm

WOODEN RETRO BLINDS 50 mm



BLIND'S HEIGHT	PACKAGE HEIGHT [CM] *	
	LADDERCORD	LADDERTAPE
50	-	15 cm
100	-	19 cm
150	-	23 cm
200	-	28 cm
250	-	32 cm
300	-	36 cm
350	-	41 cm

WOODEN RETRO BLINDS 50 mm RUSTIC



BLIND'S HEIGHT	PACKAGE HEIGHT [CM] *	
	LADDERCORD	LADDERTAPE
50	-	15 cm
100	-	20 cm
150	-	25 cm
200	-	30 cm
250	-	35 cm
300	-	40 cm
350	-	45 cm

* together with the head rail and bottom rail



NUMBER OF LADDERS IN RELATION TO THE WIDTH OF THE BLIND

The tables provided below determine the estimated number of ladders and cords for pulling-up the blinds which will be used to produce the respective types, given a specific size of a blind. Note - Blinds with similar dimensions but belonging to two different ranges (e.g. 25 mm aluminium blinds: width 1890 – 3 ladders, width 1920 – 4 ladders) **may be produced with the use of the same number of ladders.**

ALUMINIUM BLINDS:

ALUMINIUM BLINDS 25 mm

BLINDS WIDTH [mm]	NUMBERS OF CORDS	NUMBERS OF LADDERS	SCHEME	DISTANCE OF EDGE HOLES FROM THE SLAT BORDER	DISTANCE OF SIDE GUIDING HOLES FROM THE SLAT BORDER	QUANTITY OF MOUNTING BRACKETS *
≤ 375	2	2		100 mm	14 mm	2
≤ 800	2	2		125 mm		2 - 3
801 - 1400	2	3				3 - 4
1401 - 1900	4	4				4 - 5
1901 - 2600	4	5				5 - 6
2601 - 3200	4	6				6 - 7

ALUMINIUM BLINDS 50 mm

BLINDS WIDTH [mm]	NUMBERS OF CORDS	NUMBERS OF LADDERS	SCHEME	DISTANCE OF EDGE HOLES FROM THE SLAT BORDER	DISTANCE OF SIDE GUIDING HOLES FROM THE SLAT BORDER	QUANTITY OF MOUNTING BRACKETS *
≤ 525	2	2		150 mm	27 mm	2 - 3
≤ 1150 (wys. ≤ 1800)	2	2		200 mm		2 - 3
≤ 1150 (wys. ≥ 1801)	2	3				3 - 4
1151 - 1900	2	3				3 - 4
1901 - 2650	4	4				4 - 5
2651 - 3400	4	5				5 - 6
3401 - 4000	4	6				6 - 7
4001 - 5000	4	7				7 - 8

* the number of mounting brackets that should be used for mounting one piece of blinds, depending on its weight



NUMBER OF LADDERS IN RELATION TO THE WIDTH OF THE BLIND

WOODEN BLINDS:

WOODEN BLINDS 25 mm

BLINDS WIDTH [mm]	NUMBERS OF CORDS	NUMBERS OF LADDERS	SCHEME	DISTANCE OF EDGE HOLES FROM THE SLAT BORDER	DISTANCE OF SIDE GUIDING HOLES FROM THE SLAT BORDER	QUANTITY OF MOUNTING BRACKETS
≤ 375	2	2		100 mm	14 mm	2
376 - 750				2 - 3		
751 - 1350	2	3		125 mm		3 - 4
1351 - 1900	4	4				4 - 5
1901 - 2450	3	5				5 - 6
2451 - 2700	4	6				6 - 7

WOODEN BLINDS 25 mm BAMBOO

BLINDS WIDTH [mm]	NUMBERS OF CORDS	NUMBERS OF LADDERS	SCHEME	DISTANCE OF EDGE HOLES FROM THE SLAT BORDER	DISTANCE OF SIDE GUIDING HOLES FROM THE SLAT BORDER	QUANTITY OF MOUNTING BRACKETS
≤ 375	2	2		100 mm	22 mm	2 - 3
≤ 650	2	2		2 - 3		
651 - 1050 (wys. ≤ 1000)	2	3		125 mm		3 - 4
651 - 1050 (wys. ≥ 1001)	3	3				3 - 4
1051 - 1450 (wys. ≤ 1000)	2	4				4 - 5
1051 - 1450 (wys. ≥ 1001)	4	4				4 - 5
1451 - 1800	4	5		5 - 6		



Ladder



Ladder + cord for pulling up the blinds

* the number of mounting brackets that should be used for mounting one piece of blinds, depending on its weight



NUMBER OF LADDERS IN RELATION TO THE WIDTH OF THE BLIND

WOODEN BLINDS 50 mm

BLINDS WIDTH [mm]	NUMBERS OF CORDS	NUMBERS OF LADDERS	SCHEME	DISTANCE OF EDGE HOLES FROM THE SLAT BORDER	DISTANCE OF SIDE GUIDING HOLES FROM THE SLAT BORDER	QUANTITY OF MOUNTING BRACKETS
≤ 525	2	2		150 mm	22 mm	2 - 3
≤ 1000	2	2		175 mm		2 - 3
1001 - 1450	2	3				3 - 4
1451 - 1650 (wys. ≤ 1200)	2	3				3 - 4
1451 - 1650 (wys. ≥ 1201)	3	3				3 - 4
1651 - 1800 (wys. ≤ 1200)	4	4				4 - 5
1651 - 1800 (wys. ≥ 1201)	4	4				4 - 5
1801 - 2300	4	4				4 - 5
2301 - 2800	4	5				5 - 6
2801 - 3600	4	6				6 - 7

WOODEN BLINDS 50 mm BAMBOO

BLINDS WIDTH [mm]	NUMBERS OF CORDS	NUMBERS OF LADDERS	SCHEME	DISTANCE OF EDGE HOLES FROM THE SLAT BORDER	DISTANCE OF SIDE GUIDING HOLES FROM THE SLAT BORDER	QUANTITY OF MOUNTING BRACKETS
≤ 525	2	2		150 mm	22 mm	2 - 3
≤ 900	2	2		175 mm		2 - 3
901 - 1250 (wys. ≤ 1600)	2	3				3 - 4
901 - 1250 (wys. ≥ 1601)	3	3				3 - 4
1251 - 1450	3	3				3 - 4
1451 - 2000	4	4				4 - 5
2001 - 2400	4	5				5 - 6
2001 - 2400 ELECTRIC BLIND	5	5				5 - 6

* the number of mounting brackets that should be used for mounting one piece of blinds, depending on its weight



NUMBER OF LADDERS IN RELATION TO THE WIDTH OF THE BLIND

WOODEN BLINDS 50 mm FAUX WOOD PCV

BLINDS WIDTH [mm]	NUMBERS OF CORDS	NUMBERS OF LADDERS	SCHEME	DISTANCE OF EDGE HOLES FROM THE SLAT BORDER	DISTANCE OF SIDE GUIDING HOLES FROM THE SLAT BORDER	QUANTITY OF MOUNTING BRACKETS
≤ 700	2	2		150 mm	22 mm	2 - 3
701 - 1300 (wys. ≤ 1200)	2	3				3 - 4
701 - 1300 (wys. ≥ 1201)	3	3				3 - 4
1301 - 1800	4	4				4 - 5
1801 - 2300	4	5				5 - 6
2301 - 2700	4	6				6 - 7



Ladder



Ladder + cord for pulling up the blinds

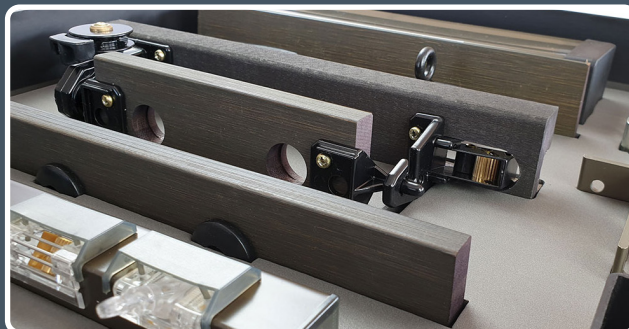

* the number of mounting brackets that should be used for mounting one piece of blinds, depending on its weight

MOTORS

The programme of electric motors is based on what is available from the leading producers in this sector, these being **SOMFY**, a French company, and **BREL** from the Netherlands. We provide a wide range of solutions, starting from traditional cable control to the increasingly popular 'smart home' EIB systems, and RTS wireless transmitters and io-homecontrol technologies, enabling remote control through mobile applications. Our innovation is a battery engine produced by **BREL**, which is installed simply without any specialised technical knowledge and without the need of supplying any power lines to the blinds. As an experienced producer of interior sunshields with electric motors, we are here to share our knowledge and experience with you, and to help you choose the best optimal solutions.

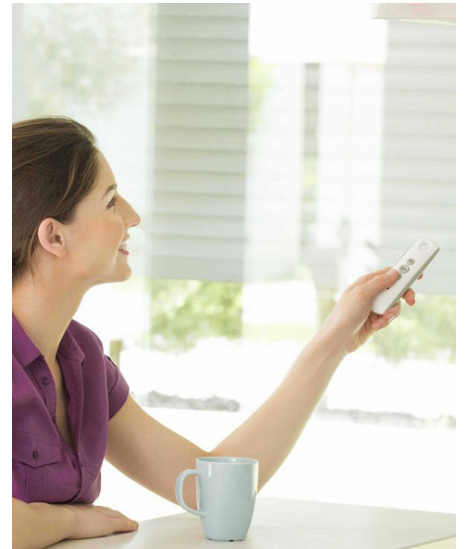

MOTORS

somfy.

TILT&LIFT RTS 12 V

The motor is adapted to be powered with 12V DC from 10 Ni-MH batteries (with the option of using a solar panel), 8 AA batteries (in a dedicated housing), or plug-in AC adapter. Controlled via radio RTS. The precision of the end limit switches operation +/- 5° guarantees the correct adjustment of the end positions of the blind - remote adjustment of end positions using RTS remote controls.

■ Somfy - 1002461



Technical data:

application:	blinds 25 mm
control:	radio RTS
radio frequency:	433.42 MHz
nominal voltage:	12 VDC
torque:	0.8 Nm
speed:	lifting 35 rpm lowering 45 rpm
level of generated noise:	36 dB
total length:	200 mm
minimal width of blinds:	0,38 m

AKKUPACK TILT&LIFT RTS

■ Somfy - 9021217



250 x 25 x 23 mm

Externer Akkupack für alle 12 V angetriebene Motoren. Dank des neuen Akkupacks können die 12V Motoren Ihrer 25mm Jalousie (Holz- oder Aluminiumjalousie) ohne verlegen von Kabel, mit Spannung versorgt werden. Der Akkupack besitzt zwei unterschiedliche Montagemöglichkeiten, Sie haben die Wahl, ob Sie es an der Wand bzw. Decke anbringen wollen oder direkt an der Oberschiene der Jalousie. Der Akkupack muss lediglich einige Male pro Jahr aufgeladen werden, wenn Sie die Jalousie täglich einmal ansteuern werden. Sie können den Akkupack entweder mit dem Steckernetzteil der Firma Somfy Artikel-Nr. 9021028 aufladen oder mit Hilfe des Solarpanels der Firma Somfy, Artikel-Nr. 9025293. Das Solarpanel sorgt für die konstante Aufladung der Batterie.

Montage Wall/Ceiling



SOLAR PANEL FOR AKKUPACK

■ Somfy - 9025293



301 x 40 x 11 mm

Technical data:

Spannungversorgung:	12 V DC SELV
Akkutyp:	Li-Ion
charging time:	6 hours max.
Akkukapazität:	2600 mAh
Betriebstemperatur:	0 °C - 60 °C
Ladetemperatur:	0 / 45 °C

Top profile mounting



LW 25-B83 24 V

Motor with nominal torque of 0.8 Nm. Centrally mounted, with built-in brake and overload limiter. Setting the end position is not necessary thanks to the integrated current measurement. The design of the motor ensures quiet and reliable operation

■ Somfy - 1000031



Technical data:

application:	blinds 25 mm
control:	wired
nominal voltage:	24 VDC
torque:	0.8 Nm
speed:	30 rpm
diameter:	24 mm
total length:	205,5 mm
minimal width of blinds:	0,53 m

SONESSE 40 PA / RTS 230V

Compact and quiet motor for internal coverings (works at the noise level below 45 dB.), powered by 230 V AC voltage. Available in two versions: wire-controlled PA and radio-controlled RTS: with various speeds and torques to choose: 3 Nm, 6 Nm or 9 Nm.

■ Somfy - PA: 1001548 - 3 Nm
1001549 - 6 Nm
1001552 - 9 Nm

RTS: 1001574 - 3 Nm
1001578 - 6 Nm
1001582 - 9 Nm



Technical data:

application:	blinds 50 mm
control:	wider PA and via radio RTS
radio frequency:	433.42 MHz
nominal voltage:	230 V / 50 Hz
speed:	torque: 3 Nm - 30 rpm 6 Nm - 20 rpm 9 Nm - 12 rpm
level of generated noise:	< 45 dB
diameter:	40 mm
total length:	from 478 mm to 548 mm
minimal width of blinds:	0,57 m

SONESSE 40 io-homecontrol® 230V

The newest version of quiet motor Sonesse 40 in the IO technology. Powered by 230 V voltage, radio-controlled io-homecontrol. The level of generated noise below 44 dB. The motor is available in several versions, with various torques: 1.3 Nm, 3 Nm, 6 Nm and 9 Nm

■ Somfy - 1003222 - 1,3 Nm
1003224 - 3 Nm
1003226 - 6 Nm



Technical data:

application:	blinds 50 mm
control:	via radio io-homecontrol
radio frequency:	868 - 870 MHz
nominal voltage:	230V / 50 Hz
speed:	torque: 1,3 Nm - 50 rpm 3 Nm - 30 rpm 6 Nm - 20 rpm
level of generated noise:	44 dB
diameter:	38,2 mm
total length:	from 517 mm to 548 mm
minimal width of blinds:	0,62 m

ON A SPECIAL REQUEST OF THE CUSTOMER OR IN A SPECIAL INSTALLATION SITUATION
THERE IS A POSSIBILITY OF APPLICATION
SOMFY J4 SERIES MOTORS*



J4 WT / RTS 230 V
J4 io-homecontrol 230 V

*minimal width of blinds 0,525 m



POWER SUPPLY UNIT (PLUG-IN) 230/24V DC, 1A

- Stabilised power supply unit.
- Can power a single motor.
- It does not require any special installation.

Technical data:	voltage (input):	207 V - 243 V
	frequency:	50 - 60 Hz
	voltage (output):	24 VDC + 3% / - 5%
	current max.:	1000 mA

■ Somfy - 1870279



POWER SUPPLY UNIT POWER 1.0 DC 24 VDC FLUSH-MOUNTED

- Small power supply unit for flush in-wall mounting.
- Perfect solution for powering a single motor.

Technical data:	voltage (input):	from 100 V to 240 V
	frequency:	50 - 60 Hz
	voltage (output):	24 V DC

■ Somfy - 1870274



POWER 1,5 DC 24 V GROUP POWER SUPPLY UNIT

- Surface mounting.
- Can power up to 3 motors.
- Mains plug sold separately

Technical data:	voltage (input):	90 V - 264 V
	frequency:	43 - 67 Hz
	voltage (output):	24 VDC (90 do 240 VDC)
	current max.:	1500 mA

■ Somfy - 1870149



POWER 2,5 DC RTS GROUP POWER SUPPLY UNIT

- Power supply unit with integrated RTS receiver ~ 230V/ 24V DC.
- Can power and control up to 6 motors.
- Compatible with all RTS Somfy transmitters.

Technical data:	voltage (input):	198 V - 255 V
	frequency:	50 Hz
	voltage (output):	24 VDC
	current max.:	2500 mA

■ Somfy - 1870157



POWER 2,7 DC 24 V

- Surface mounting
- Can power up to 6 motors.

Technical data:	voltage (input):	198 V - 255 V
	frequency:	50 Hz
	voltage (output):	24 VDC +/- 5%
	current max.:	2700 mA

■ Somfy - 1870156



ANIMEO DC 230 V AC / 24 V DC GROUP POWER SUPPLY UNIT

- Surface mounting.
- Can power up to 11 motors.
- Stabilised power supply unit.

Technical data:	voltage (input):	220 V - 240 V
	frequency:	50 - 60 Hz
	voltage (output):	24 VDC +/- 5%
	current max.:	4500 mA

■ Somfy - 1860093





POWER SUPPLY 12 V FOR THE TILT & LIFT RTS MOTOR

somfy®

POWER SUPPLY UNIT FOR 12V WIREFREE MOTOR

- Does not require any additional service.
- Can power a single motor.
- Output short-circuit protection.

Technical data:
 voltage (input): : from 100 to 240 V
 frequency: : 50 - 60 Hz
 voltage (output): : 12 VDC
 current max.: : 2000 mA

■ Somfy - 1822445



SOLAR ENERGY PACK FOR A WIREFREE DRIVE

(SOLAR PANEL, CABLE, WALL MOUNT CLIPS)

- Does not require any tools or electrical installations.
- Perfect for all Somfy 12 V WireFree motors.
- Batteries sold separately.

Technical data: voltage (input): : 12 V

■ Somfy - 9019034



BATTERY TUBE FOR A WIREFREE DRIVE + CLIPS

- Available in two variants: for 8 AA lithium batteries or for 10 rechargeable. Includes wall mount clips, screws and plastic protection for battery tube. Batteries sold separately.

■ Somfy - 9018685 - 8x AA
 9018608 - 10x NIMH



AC ADAPTER

- NiMH battery charger

■ Somfy - 9018620



WIRE CONTROL 24 V FOR THE LW 25 B83 MOTOR

somfy®

INIS DC 24 V POWER SUPPLY SWITCH

- A single control switch integrated power supply unit for a 24 VDC wire-controlled motor.
- Easy installation in a standard flush-mounted box or in a surface mounted housing.

Technical data:
 voltage (input): : 233 V
 frequency: : 50 Hz
 voltage (output): : 24 VDC
 current max.: : 700 mA

■ Somfy - 1870071





SMOOVE UNO / DUO SWITCH (FIXED POSITION FP)

- Somfy Wire switches for control of wire motors
- Smoove UNO (fixed position) - for a single motor.
- Smoove DUO (fixed position) - independent control of two motors.
- Pressing the button causes the motor to move up / down to the end position.
- Press any button to stop the motor.

- Somfy Smoove Uno - 1800508
- Somfy Smoove Duo - 1800506



SMOOVE UNO IB+ SWITCH

- Wire switch for manual control of a single 230 V motor.
- Control by UP, DOWN and STOP/MY buttons.
- Programming the comfort position by „my“ function.
- Possibility to connect to two central control systems due to operation with IB and animeo IB+ buses.
- Easy and fast assembly in a 60 mm installation box.

- Somfy - 1811203 - pure
- 1811204 - silver
- 1811205 - black



NOTE: Each colour - different price.
Set does not contain a frame.

SMOOVE ORIGIN IB+ SWITCH

- Manual central or group control of many motors while using the IB+ bus.
- It is used as a master in combination with individual controllers e.g. Centralis Uno IB, Smoove Uno IB.
- Compatible in terms of design with the Somfy Smoove Uno IB+ series.

- Somfy - 1811272



Set does not contain a frame.

CHRONIS SMOOVE UNO TIME PROGRAMMER

- Can control the wire controlled 230 V motors.
- Large back-lit touch screen enables easy control and programming while using the text display.
- Modern design, and 2 colour options allow free combination of the Chronis Smoove Uno programmer with other products from the Smoove series.

- Somfy - 1805268



SEPARATING RELAY TR2-U-E-230

- A relay for group control of roller blinds motors with mechanic or electronic switches used for a parallel connection of motors.
- A single relay can connect up to 2 motors.
- More motors require using several separating relays connected to each other. For several separating relay the supply with the same phase is necessary.
- By means of the control inputs only the current of the relay coil is controlled, not the motor. The controller current load is minimum.

- Somfy - 1822200



Our company is a member of the prestige „Powered by Somfy“ program. Participation in this program confirms the highest quality of offered products and confirms the top quality of customer service.



SMOOVE ORIGIN RTS WALL SURFACE-MOUNT SWITCH

- Depending on the selected model, it is possible to control one or more devices or groups of devices.
- Compatible with all RTS powered systems (internal & external).
- Battery powered - no wiring required.
- Supplied with a mounting plate easy and quick to install on a wall, flush-mounted installation nest is not required.

- Somfy - 1811045 - Single channel switch
- Somfy - 1800223 - Two channel switch
- Somfy - 1800295 - Four channel switch

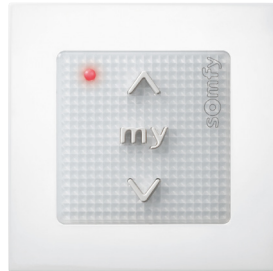

Set contains a frame.

SITUO 1 Variation RTS II - PURE COLOUR (GREY + WHITE)

- Controlling one device or one group of devices using RTS technology.
- A new rotation regulator enables precise control of the inclination angle of the blind slats.
- The "We" function allows you to define your favourite comfort position.

- Somfy - 1811608



Pilot w kolorze IRON
jest dostępny na zamówienie.
- nr Somfy: 1811609

Elegant and discreet
wall mount

PILOT SITUO 5 Variation RTS II - PURE COLOUR (GREY + WHITE)

- Controlling five devices or five groups of devices using RTS technology.
- A new rotation regulator enables precise control of the inclination angle of the blind slats.
- The LED display confirms transmission of a radio signal and indicates the currently selected channel.
- The "We" function allows you to define your favourite comfort position.

- Somfy - 1811610



Elegant and discreet
wall mount

TELIS 16 PURE HAND-HELD - COLOUR PURE (WHITE)

- 16-channel remote control.
- Can control a single motor or up to 16 groups of motors at the same time.
- Compatible with all external and integrated RTS receivers.
- The on-screen makes it easy to program and navigate through settings. You can assign each channel a name, icon and/or number.
- Powered by batteries, displays battery charge level.

- Somfy - 1811079



Colour Silver is available at request. NOTE: each colour - different price.

TELIS CHRONIS 6 REMOTE CONTROL

- 6-channel remote control with LED display.
- Can control a single motor or up to 6 groups of motors at the same time.
- Both: manual mode and time scheduled automatic mode available.
- Different scheduled operation available for each day of a week, up to 6 different timed events per day.
- The twilight function (closure at sunset), holidays mode functions and automatic summer / winter time change.

- Somfy - 1805215





SIMU HZ 5-CHANNEL RADIO TRANSMITTER

- Wireless transmitter enables individual control of 5 roller blinds or 5 groups of roller blinds with the possibility to create areas and central control of a home.
- The pre-programmed ALL channel, ensures simultaneous operation of all 5 channels.
- LCD display enables to name each channel with 2 marks.
- Low battery warning signal.

Available in two versions:

■ Simu - 2008335

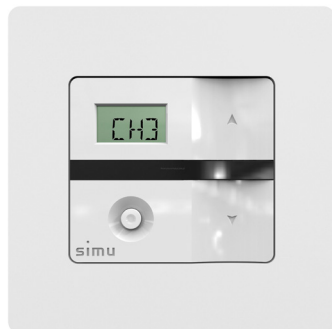

Wall surface version – mounted in a chosen place.

■ Simu - 2008798



Portable version - always close at hand.



SIMU transmitters are compatible with all SOMFY motors in the RTS technology.



RECEIVERS RTS 24 V



MODULIS DC 24 V EXTERNAL RADIO-BROADCAST RECEIVER

- Compatible with transmitters, Mod/Var function and Sunis sensor.
- Possibility for individual and group control (max. 2 motors).

Technical data:

radio frequency :	433,42 MHz
voltage (output):	24 VDC
current max. :	1300 mA

■ Somfy - 1870138





SMOOVE ORIGIN io

- Depending on the selected model, it is possible to control one or more devices or groups of devices.
- Possible individual, group and central control.
- Wireless - powered by batteries, and thus minimal cost of installation.
- Mounting plate enables simply and fast installation on a wall, a UP plug-in socket is not required.

- Somfy - 1811003 - Single channel switch
- Somfy - 1800204 - Two channel switch
- Somfy - 1800205 - Four channel switch



Set contains a frame.



SITUO 1 Variation io II

- Controlling one device or one group of devices using io technology.
- A new rotation regulator enables precise control of the inclination angle of the blind slats.
- The "We" function allows you to define your favourite comfort position.

- Somfy - 1870363



Elegant and discreet wall mount

SITUO 5 Variation io II

- Controlling five devices or five groups of devices using io technology.
- A new rotation regulator enables precise control of the inclination angle of the blind slats.
- The LED display confirms transmission of a radio signal and indicates the currently selected channel.
- The "We" function allows you to define your favourite comfort position.

- Somfy - 1870369



Elegant and discreet wall mount



TAHOMA® SWITCH

Tahoma Switch is one of the most comprehensive intelligent home control systems. It allows you to control over 200 devices in radio technology IO, RTS or Zigbee from a smartphone or tablet.

A simple and intuitive mobile application allows you to control, lighting, heating, gates, roller blinds or an alarm. Tahoma Switch allows you to create up to 40 individual scenarios and schedules tailored to your lifestyle. It is a way to reduce energy consumption, improve safety and comfort.

The control panel has two manual buttons. Each of them allows you to play a pre-programmed scenario without having to turn on the mobile application. Just press one of them and Tahoma will start the particular sequences, e.g. „leaving the house“, turning off the lighting, covering the blinds, lowering the temperature and activating the alarm or the „WAKE UP“ scenario, which will make the house wake up with you, e.g. opening the blinds, turning on the light, coffee machine and your favorite music.



Does not operate „tilting“ of slats in „IO“-Motors.

**MOTOR BREL BLE35-10 12 V**

12 V motor from Dutch producer Brel, and supplied with an integrated multiple charging battery and a nominal torque of 10 Nm. The battery is charged with a dedicated charger. Operated by means of a remote control device or wall switch.

**BREL-Motors****Technical data:**

application:	blinds 50 mm
control:	wireless
nominal voltage:	12 V
torque:	10 Nm
speed:	9 rpm
diameter:	35 mm
total length:	670 mm
minimal width of blinds:	0,74m

MOTOR BREL BLEQ 35-6 12 V

12 V motor from Dutch producer Brel, and supplied with an integrated multiple charging battery and a nominal torque of 6 Nm. The battery is charged with a dedicated charger. Operated by means of a remote control device or wall switch.

**BREL-Motors****Technical data:**

application:	blinds 50 mm
control:	wireless
nominal voltage:	12 V
torque:	6 Nm
speed:	24 obr. / min.
diameter:	35 mm
total length:	694 mm
minimal width of blinds:	0,78 m

MOTOR BREL BEQ 35 230V**BREL-Motors****Technical data:**

application:	blinds 50 mm
control:	wireless
nominal voltage:	230 V
torque:	speed: 6 Nm - 28 obr. / min. 10 Nm - 17 obr. / min.
diameter:	35 mm
total length:	590 mm
minimal width of blinds:	0,67m

MOTOR BREL MBQ 35 230V**BREL-Motors****Dane techniczne:**

application:	blinds 50 mm
control:	beprzewodowe
nominal voltage:	230 V
torque:	speed: 6 Nm - 28 obr. / min. 10 Nm - 17 obr. / min.
diameter:	35 mm
total length:	590 mm
minimal width of blinds:	6 Nm - 0,63 m 10 Nm - 0,67 m



MOTO BREL BJE24D 12 V

Motor with a nominal torque of 0.8 Nm. Designed for 12 V power supply via an external battery or plug-in mains adapter. Controlled by radio signal (remote control, wall switch) or mobile app via Home Hub.



Technical data:

application:	:	blinds 25mm
plug type:	:	JST
control:	:	radio/ BiDirect
nominal voltage:	:	12 V
torque:	:	0,8 Nm
speed:	:	34 obr. / min.
diameter:	:	24 mm
total length:	:	210 mm
minimal width of blinds:	:	0,48 m



DD-2712 REMOTE CONTROL PANEL

- 15-channel remote control panel
- Legible display
- Controlled by means of pressing up, down, and stop buttons
- TILT function – setting the slats tilt
- Power supplied by CR2450 battery
- Magnetic wall holder included.



DD-2773 WALL SWITCH

- 15-channel switch
- Legible display
- Controlled by means of pressing up, down, and stop buttons
- Power supplied by CR2450 battery
- Wall holder included.



DD-2712 REMOTE CONTROL PANEL

- 15-channel remote control panel.
- Legible display.
- Controlled by means of pressing up, down, and stop buttons.
- TILT function – setting the slats tilt.
- Power supplied by CR2450 battery.





CHARGER DC-212

- 230 V AC / 12 V DC.
- When the battery is fully charged, the LED on the charger will change color from red to blue.



DD-2700 REMOTE CONTROL PANEL

- 1-channel remote control panel.
- Controlled by means of pressing up, down, and stop buttons.
- Power supplied by CR2450 battery.
- Magnetic wall holder included.



DD-2702 REMOTE CONTROL PANEL

- 15-channel remote control panel.
- Legible display.
- Controlled by means of pressing up, down, and stop buttons.
- Power supplied by CR2450 battery.
- Magnetic wall holder included.



DD-2770 WALL SWITCH

- 1-channel switch.
- Controlled by means of pressing up, down, and stop buttons.
- Power supplied by CR2450 battery.
- Wall holder included.



SMART HOME



BREL HOME HUB BI-DIRECTIONAL DD-1554

Brel Home Hub is a WI-FI bridge that allows you to control your Brel motors via a mobile app. Up to 20 scenarios can be created to fully automate the sunshades in your home. Brel Home Hub allows two-way communication with more than 30 drives.

Technical data:

- power: Micro USB DC 5V/1A*
- Wi-Fi: 2,4 GHz
- frequency: 433,92 MHz
- dimensions: 65 x 20 x 15 mm





CHARGER WITH DIN CONNECTOR DC-212

- 230 V AC / 12 V DC.
- When the battery is fully charged, the LED on the charger will change color from red to blue.



CHARGER USB DC-220



BATTERY DC-1201

- 950 mAh battery to power the drives.
- Battery rechargeable via solar panel.
- Plug type: DIN and JST.
- Dimensions: 105x24 mm.



BATTERY DC-1277

- 2600 mAh battery to power the drives.
- Battery rechargeable via solar panel.
- Plug type: DIN and JST.
- Available in white or black.
- Dimensions: 245x30x30 mm.



CABLE WITH DIN CONNECTOR Z-41

- Available in length: 25 cm, 50 cm, 100 cm, 200 cm.



CABLE WITH JST CONNECTOR Z-41

- Available in length: 25 cm, 50 cm, 100 cm, 200 cm.



POWER SUPPLY WITH JST CONNECTOR DC-202

- 12 V power supply with JST connector for direct power supply to the motors



SOLAR PANEL WITH DIN CONNECTOR DC-1290

- For charging battery motors and external batteries.
- Plug type: DIN.
- Dimensions: 558x65x10 mm.



VENETIAN BLINDS

SAMPLE MODELS

The rich collection of top quality wooden and aluminium slats gives extensive arrangement possibilities. Depending on the selected slat type, venetian blinds will perfectly match classic styles as well as modern ones. If you would like to see these most interesting inspirations, and if you want to get inspired more, then just visit us at www.shadow-system.com







Shadow-System Sp. z o. o.

Kawle Dolne 4F,
83-304 Przodkowo

tel. +48 58 550 08 80

fax. +48 58 550 76 52

info@shadow-system.pl

www.shadow-system.pl



Venetian Blinds
Product Brochure